

TRONXY 3D PRINTER X3

ASSEMBLY GUIDE V.03

Step 1 Assemble Base Frame

Parts:

2020 Aluminium profile 375mm – 4pcs

Acrylic corner cushion – 4pcs

L-Shape connector (with grub screw) – 4pcs

M4-10mm screw – 12pcs

M4 T-Nut – 12pcs

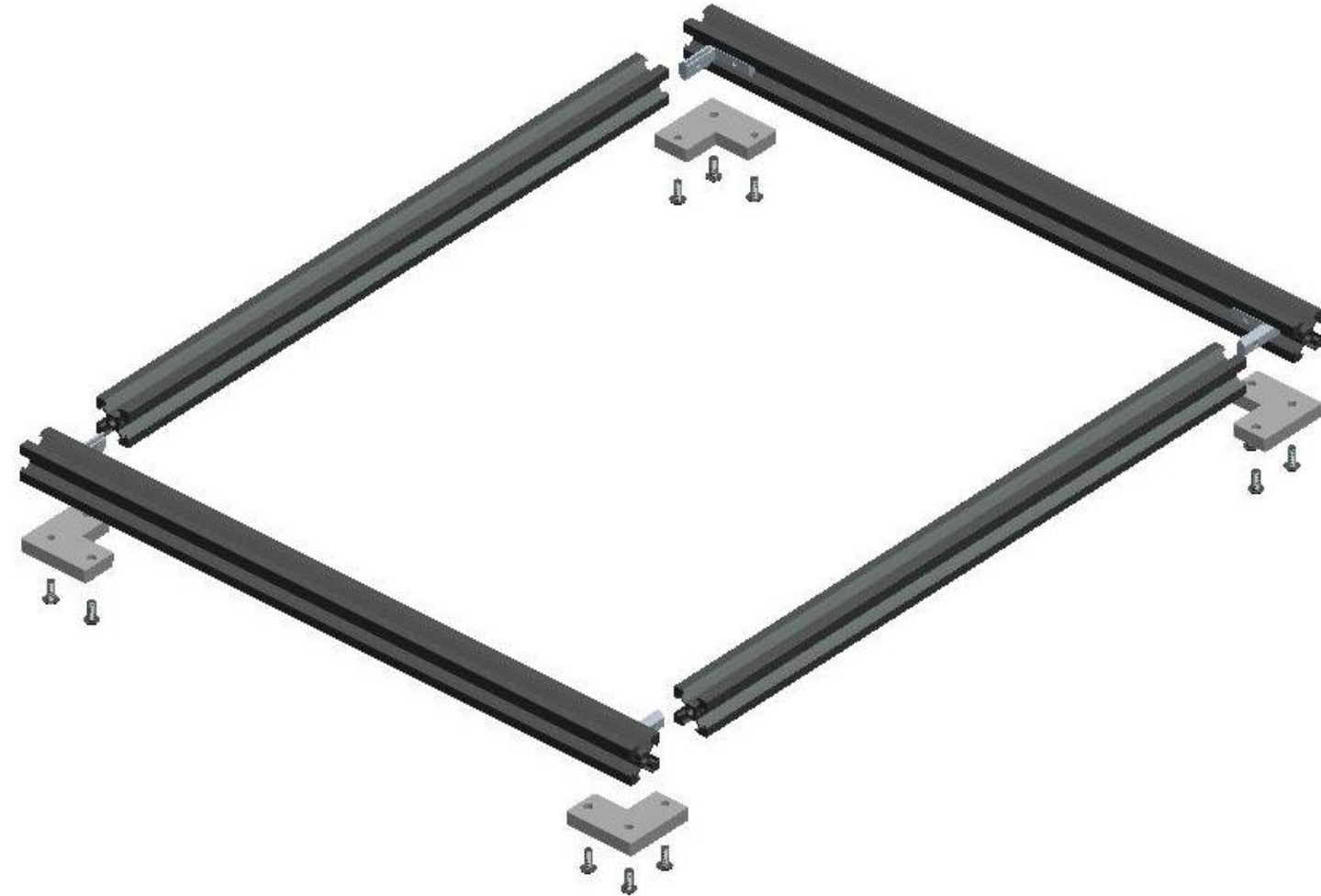

- Connect each aluminium profiles using 4pcs L-Shape connector, then tighten the grub screws.
- Mount the 4pcs acrylic corner cushion, secure them with M4-10mm screw and T-Nut.

Step 2 Placing Z-axis Slide Rail

Parts:

2020 Aluminium profile 440mm – 2pcs

Corner bracket – 4pcs

M5-25mm screws -2pcs

M4-8mm screws – 8pcs

M4 T-Nut – 8pcs

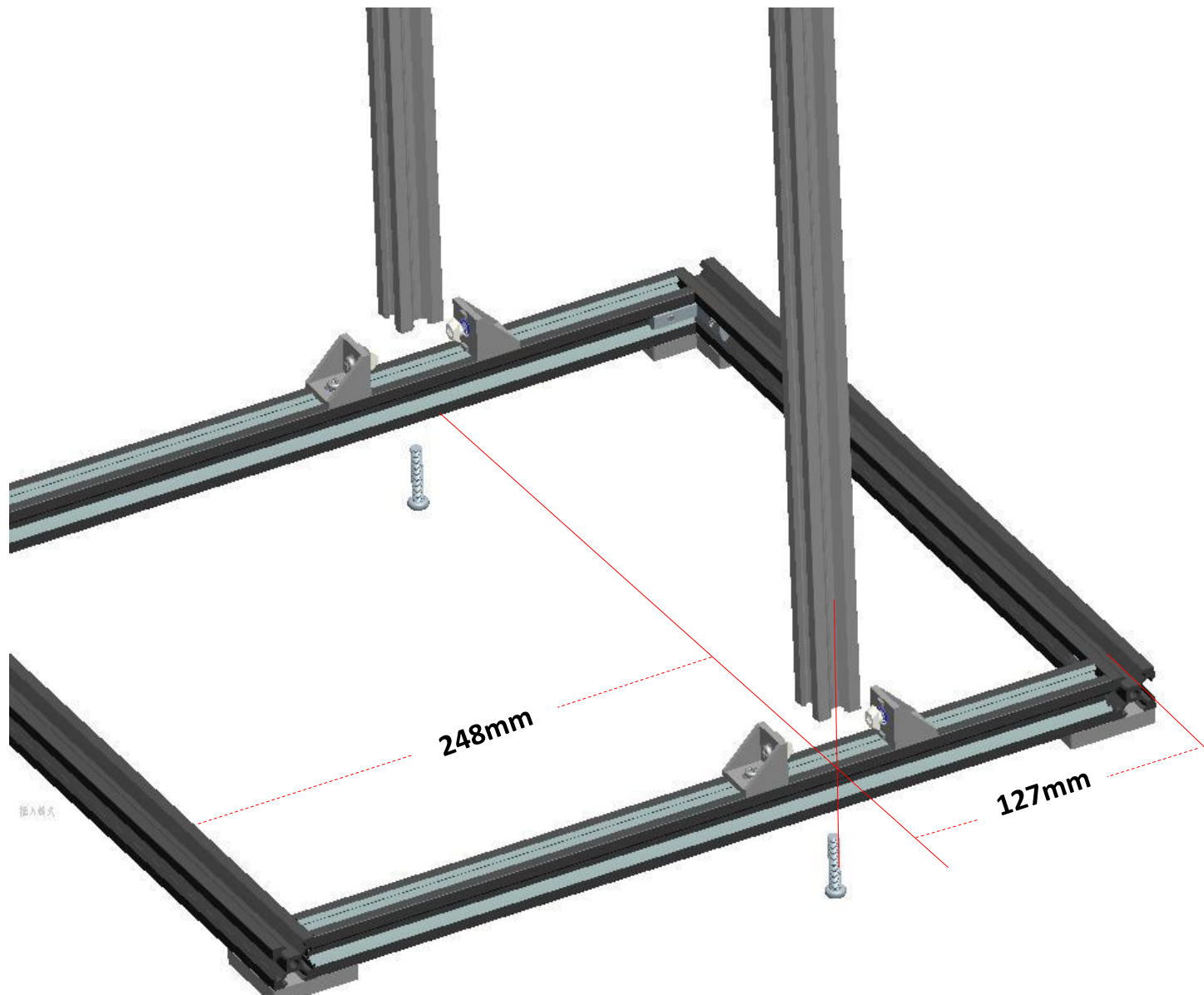

- Place 2pcs 440mm aluminium profiles on the base , secure them with M5-25mm screws.
- Fix the Z-axis slide rails using 4pcs corner bracket, secure them with M4-8mm and T-Nuts
- ⚠ Ensure the correct distance.
(Front – 248mm , Back – 127mm)

Step 3 Assemble Z Motor Bracket

Parts:

42 Motor bracket – 2pcs

M4-8mm – 4pcs

M4 T-Nut – 4pcs

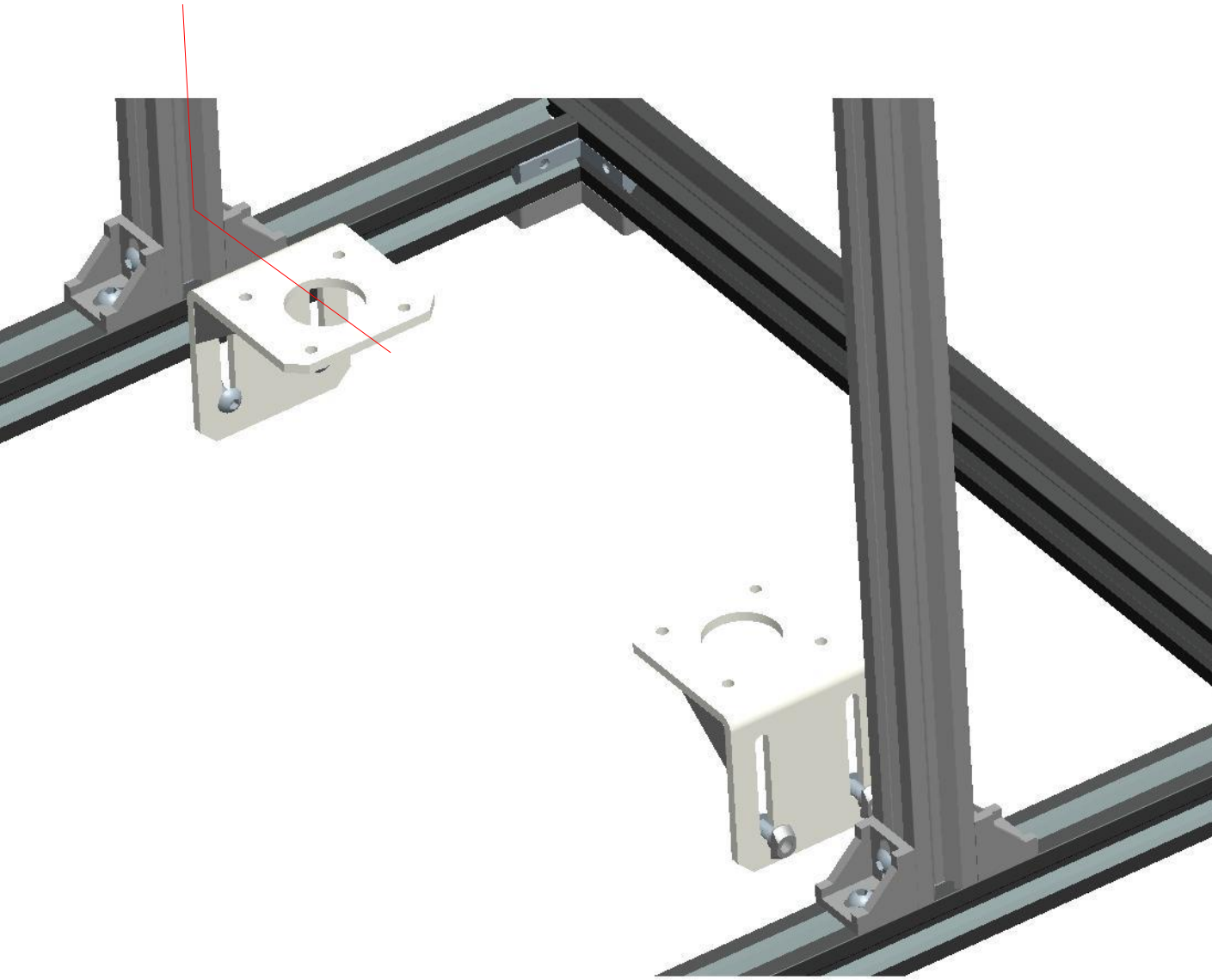

- Attach the motor bracket to the bottom of Z slide rail , **both centre lines must be vertical**. Then secure them with M4-8mm screw and T-nuts.

Step 4 Assemble Bed Frame

Parts:

2020 Aluminium profile 415mm – 1pcs

Bed frame – 1pcs

Wheel – 4pcs

Plastic pillar – 4pcs

M5-35mm- 4pcs

M5 Nut – 4pcs

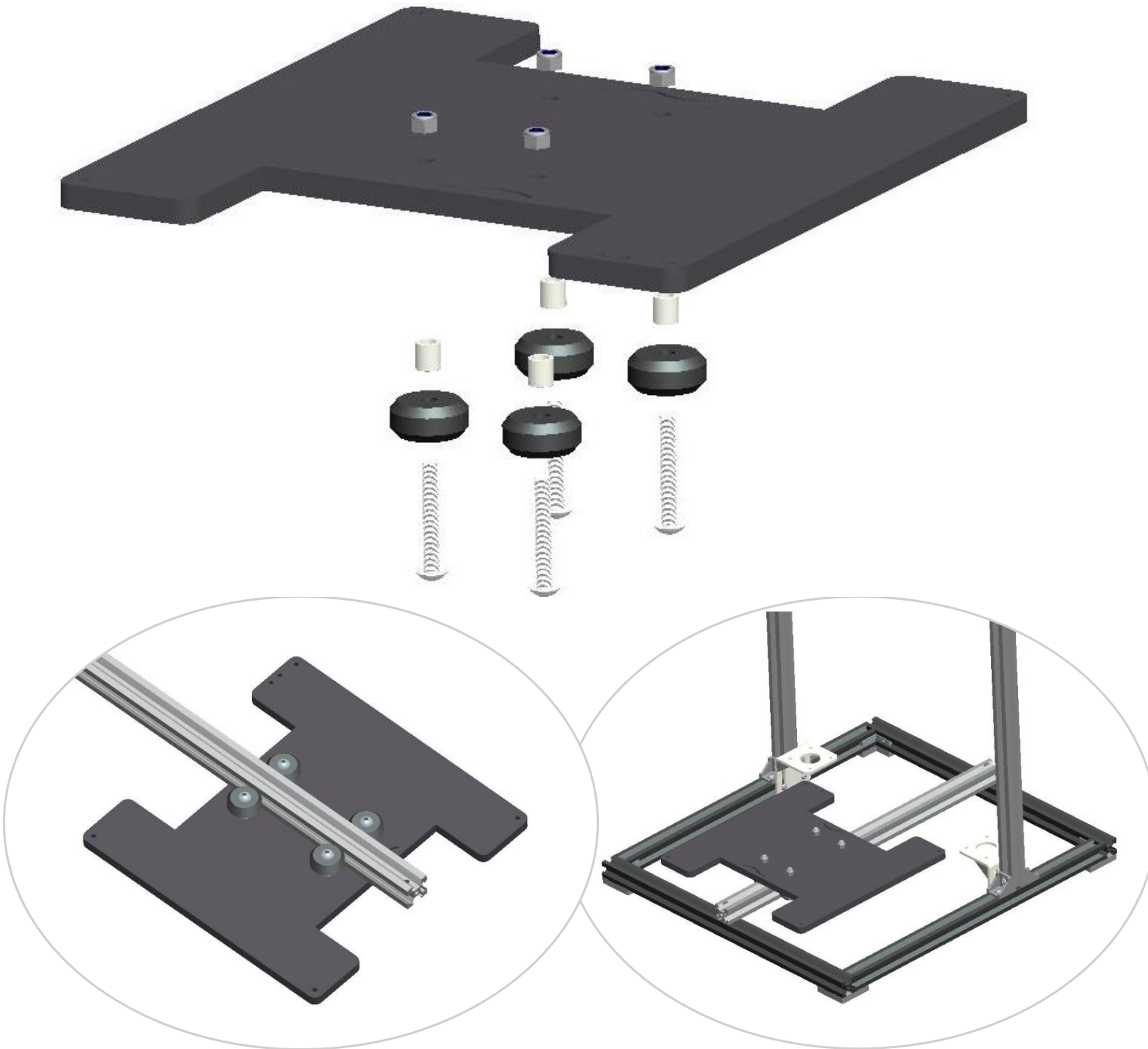

- Secure the wheels in place using M5-35mm screws and nut ,using plastic pillar between wheel and bed frame.

- Insert the aluminium profile between the wheels and add this assembly to the base frame made previously.

Step 5 Placing Y-axis Slide Rail

Parts:

- Corner bracket – 2pcs
- M4-8mm screw – 4pcs
- M4 T-Nut – 4pcs

- Place each end of the Y axis slide rail to the middle of the base aluminium profiles. Connect them with corner bracket, next secure it using M4-8mm screw and T-nut.

- ⚠ The 2pcs corner bracket had been smoothed flat. different than others.

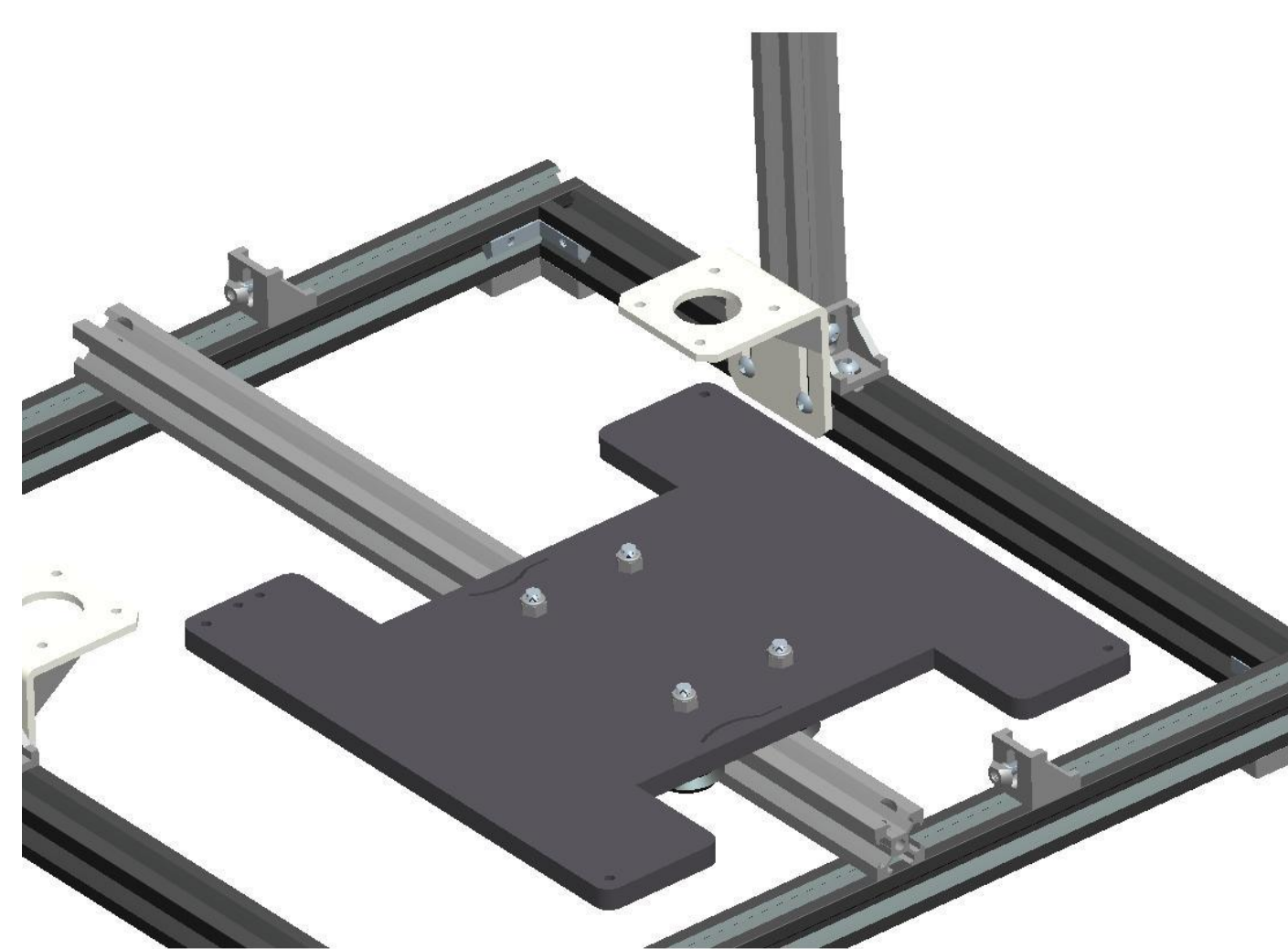
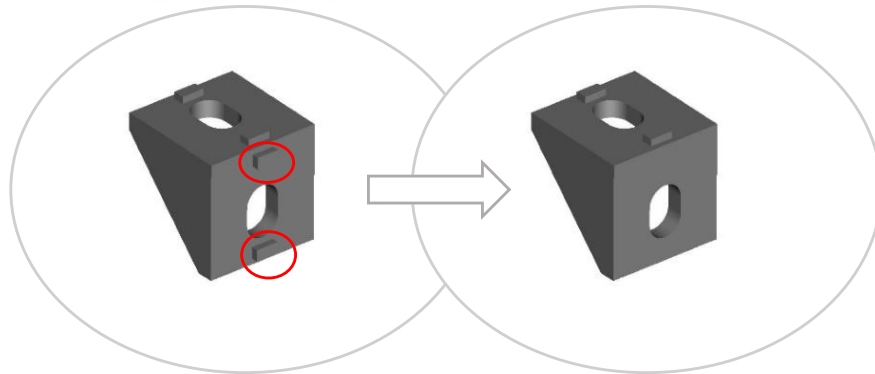

Step 6 Assemble Y-axis Belt Pulley

Parts:

Belt pulley – 1pcs

Y Pulley mount (acrylic) – 1pcs

M5-25mm screw – 1pcs

M5 Nut – 2pcs

M6 washer – 2pcs

M5 washer – 2pcs

M4-8mm screw – 2pcs

M4 T-Nut - 2pcs

- Take 1pcs M5-25mm screw and insert the Pulley mount, secure it with M5 nut , then insert the washers and belt pulley , secure them using M5 nut.

- Secure the Y belt pulley assembly to the front of the Y slide rail using 2pcs M4-8mm screws and nuts.

- ⚠ Tighten screws gently to avoid damaging the acrylic.

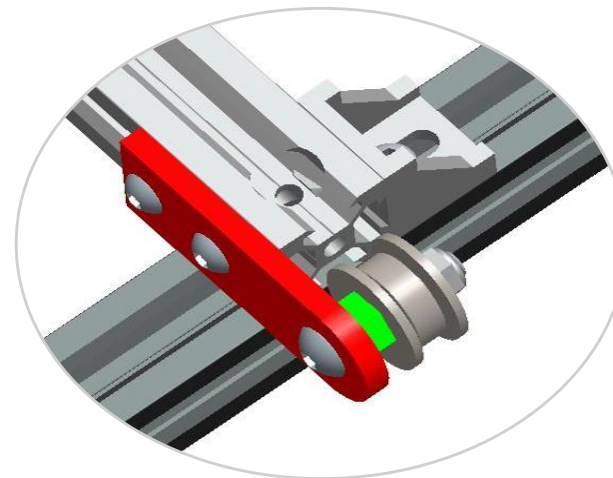
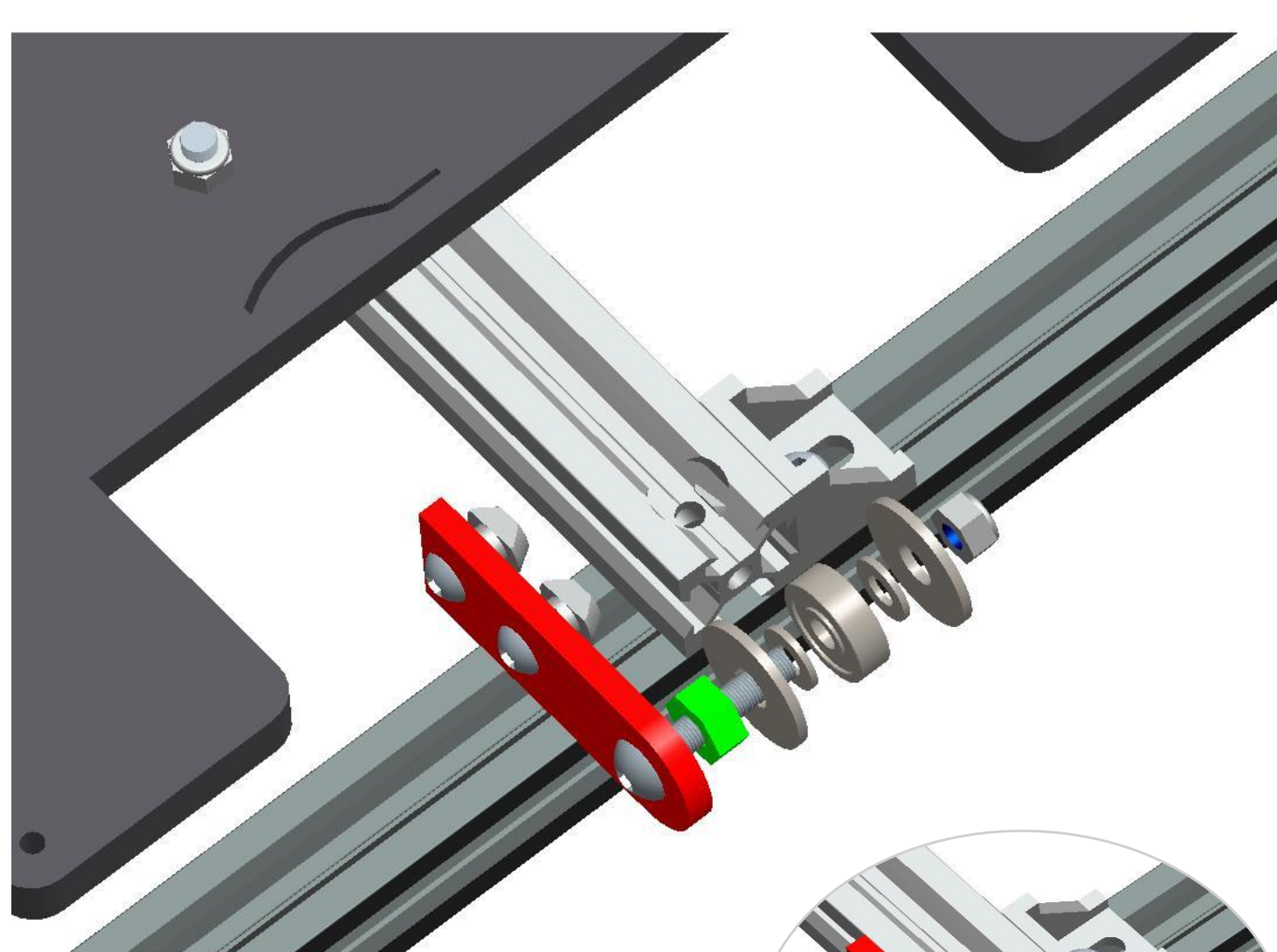

Step 7 Assemble Y axis Motor

Parts:

Limit switch – 1pcs

42 stepper motor – 1pcs

GT2-16 Pulley (with grub screw in it)– 1pcs

Y motor mount (Acrylic) – 1pcs

M3-6mm screw – 4pcs

M4-8mm screw – 2pcs

M4 T-Nut - 2pcs

M2-10mm screw – 2pcs

M2 Nut – 2pcs

- Secure the limit switch to motor mount using 2pcs M2-10mm screws and nuts. Then secure the motor mount to the back of the Y slide rail using 2pcs M4-8mm screws and T-nuts.

- Insert the GT2-16 pulley to the motor shaft, tighten the grub screw in the pulley. Next Secure the stepper motor to the motor mount using 4pcs M3-6mm screws.

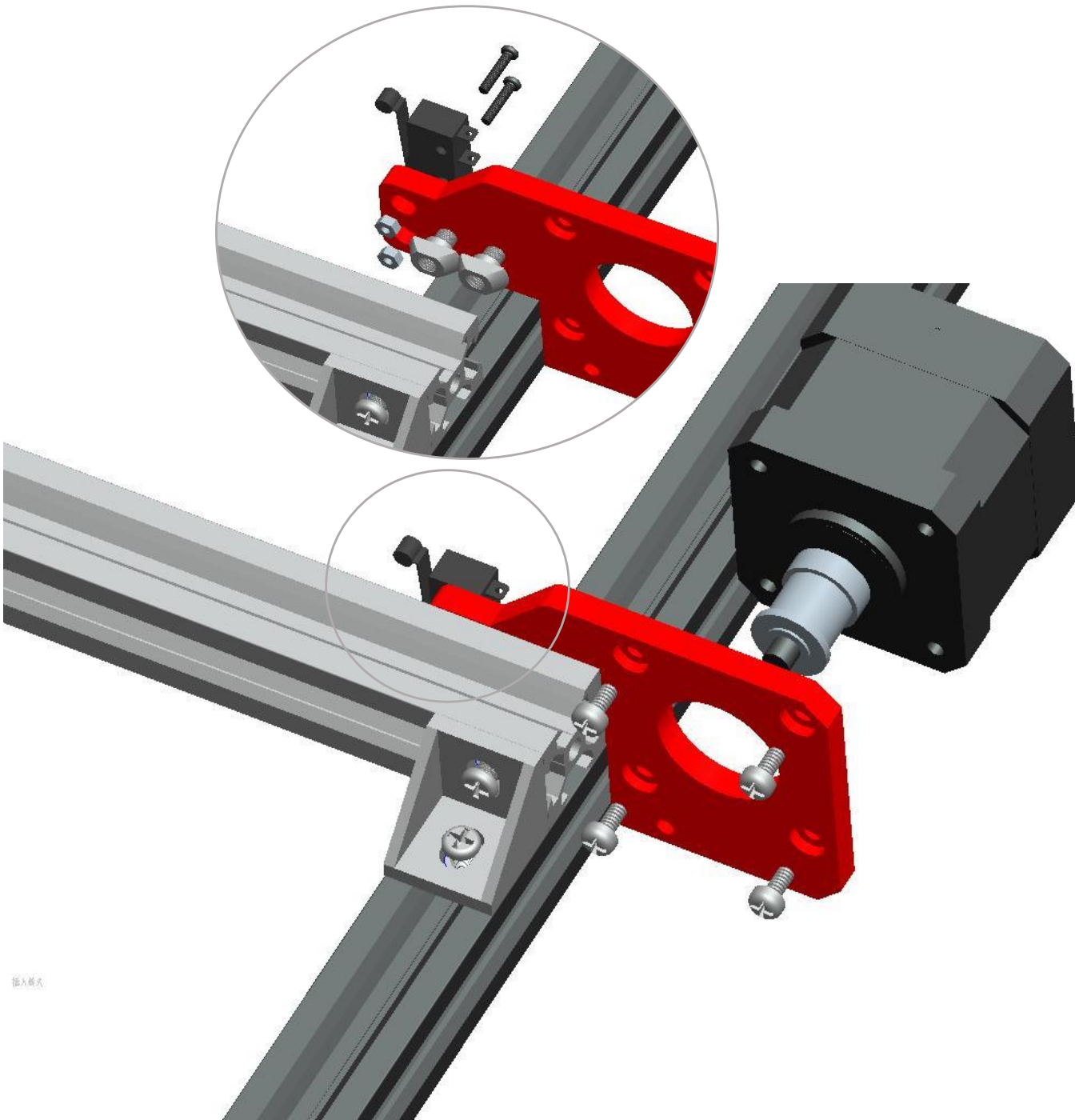

Step 8 Instal Y axis Timing Belt

Parts:

GT2 Timing belt – 1pcs

Zip-ties – 2pcs

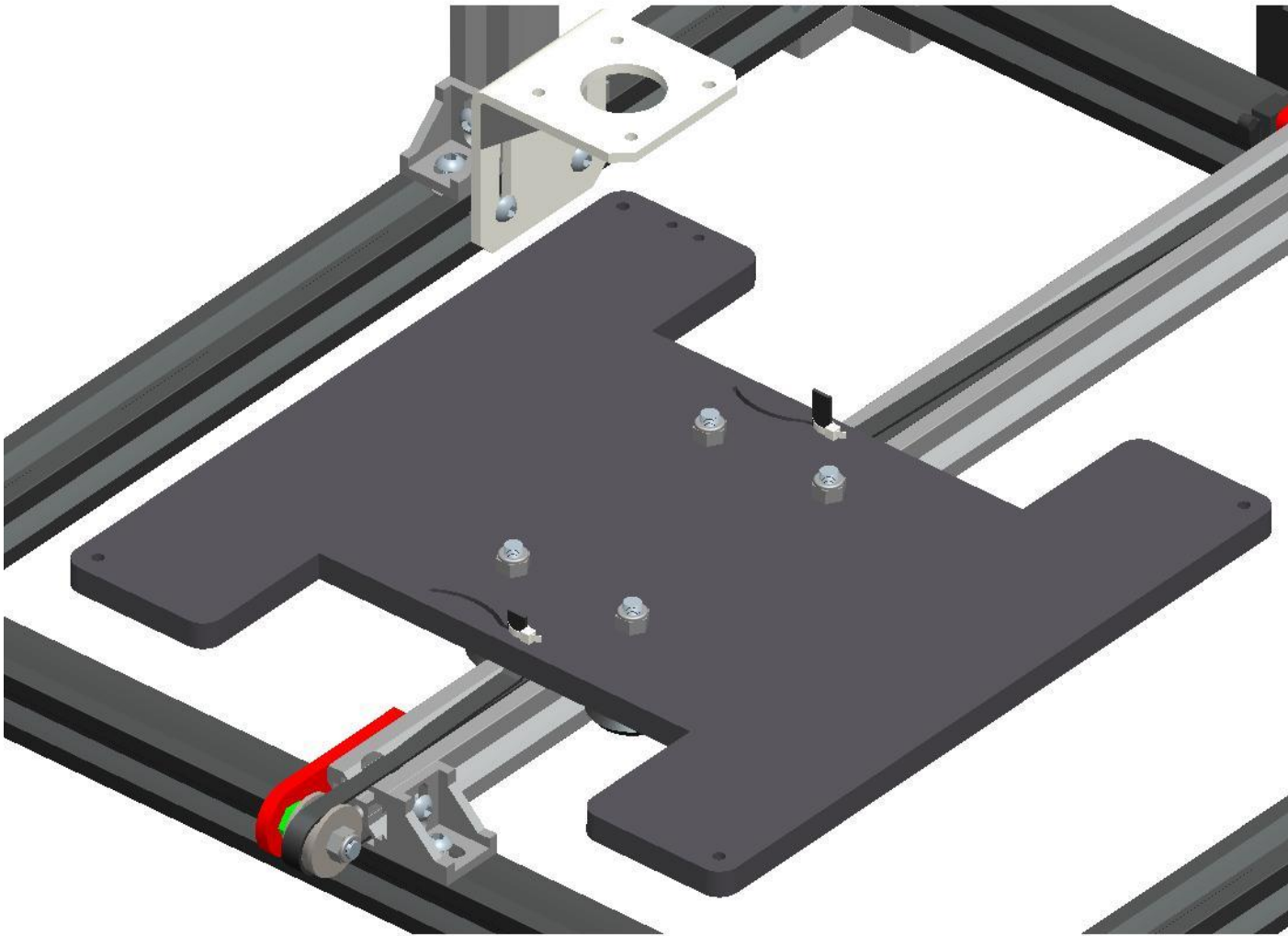

- Tighten one end of the timing belt to the bed frame using a zip-ties .
- Run the other end of timing belt along the aluminium profile, through the Y-GT2-16 Pulley and Belt pulley . Then tighten it to the bed frame using zip-ties as shown in the picture .

Step 9 Assemble Z Carriage_Left

Parts:

42 Motor bracket – 1pcs

Sliding plate (acrylic) – 2pcs

Brass nut – 1pcs

Brass nut holder_L – 1pcs

Plastic pillar – 6pcs

Wheel – 3pcs

M5-45mm screw – 3pcs

M4-12mm screw – 6pcs

M3-16mm screw – 2pcs

M5 Nut – 3pcs

M4 Nut – 6pcs

M3 Nut – 2pcs

- Assemble the motor bracket and one sliding plate using 4pcs M4-12mm screws and nuts.
 - Put the brass nut into the holder_L using 2pcs M3-16mm screws and nuts, then secure the holder with one sliding plate using 2pcs M4-12mm screws and nuts.
 - Insert 3pcs M5-45mm screws to the sliding plate, Put the wheels into M5-45mm screws, using plastic pillars between wheel and acrylic, secure them using M5 nuts.
- ⚠ Please pay attention to the installing direction.

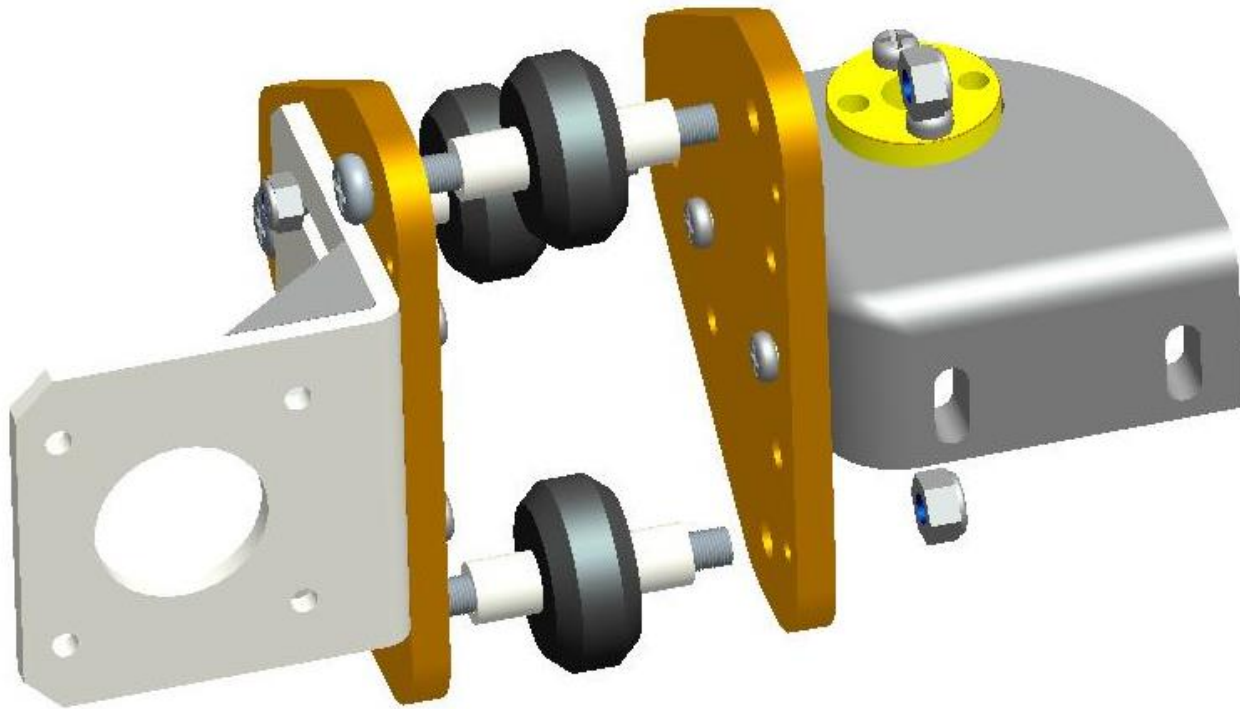
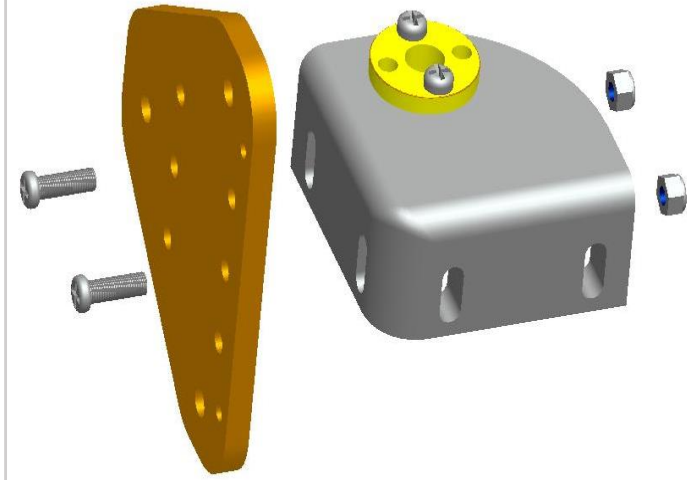
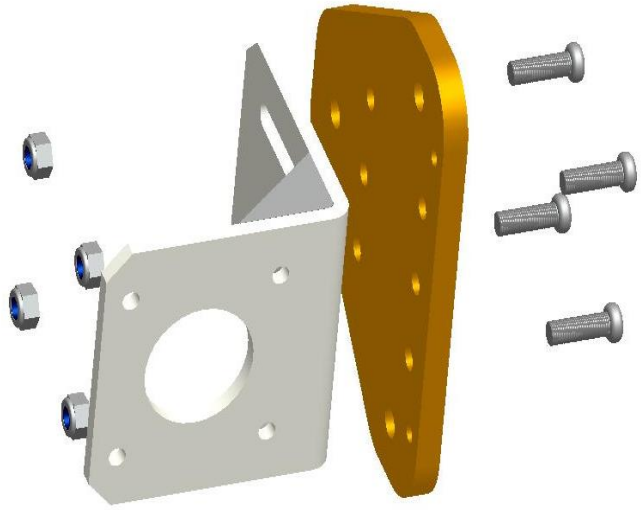

Step 10 Assemble Z Carriage_Right

Parts:

42 Motor bracket – 1pcs
Sliding plate(acrylic) – 2pcs
Brass nut – 1pcs
Brass nut holder_R – 1pcs
Plastic pillar – 6pcs
Wheel – 3pcs
M5-45mm screw – 3pcs
M4-12mm screw – 6pcs
M3-16mm screw – 2pcs

M5 Nut – 3pcs
M4 Nut – 6pcs
M3 Nut – 2pcs

- Put the brass nut into the holder_R using 2pcs M3-16mm screws and nuts, then secure the holder with one sliding plate using 2pcs M4-12mm screws and nuts.
 - Assemble the motor bracket and one sliding plate using 4pcs M4-12mm screws and nuts.
 - Insert 3pcs M5-45mm screws to the sliding plate, Put the wheels into M5-45mm screws, using plastic pillars between wheel and acrylic, secure them using M5 nuts.
- ⚠ Please pay attention to the installing direction.

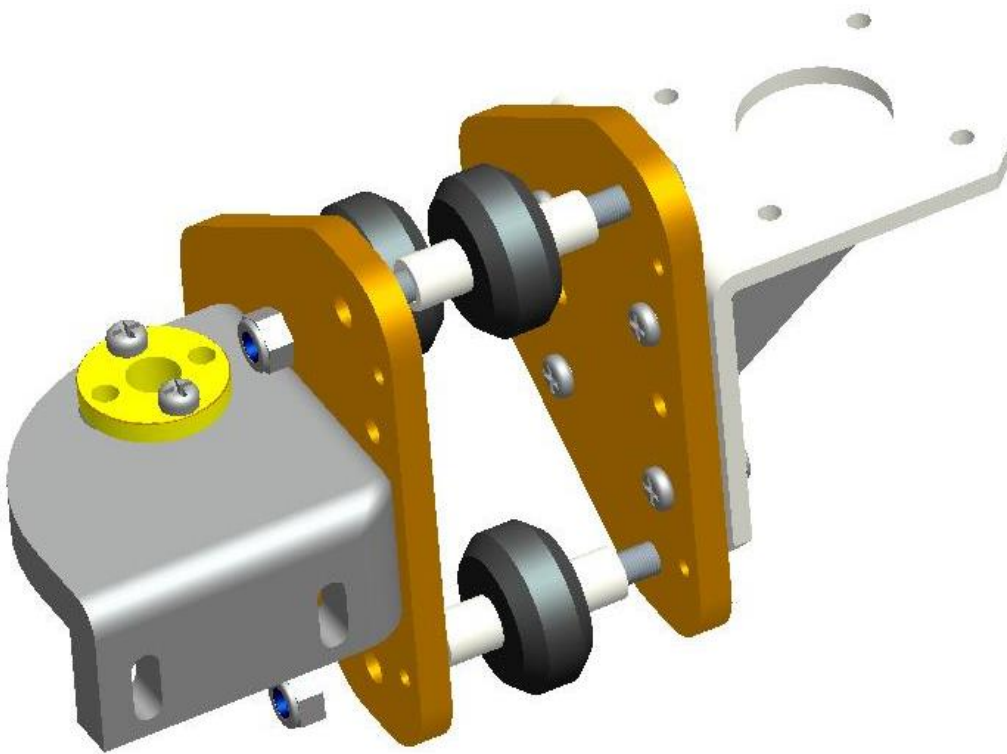
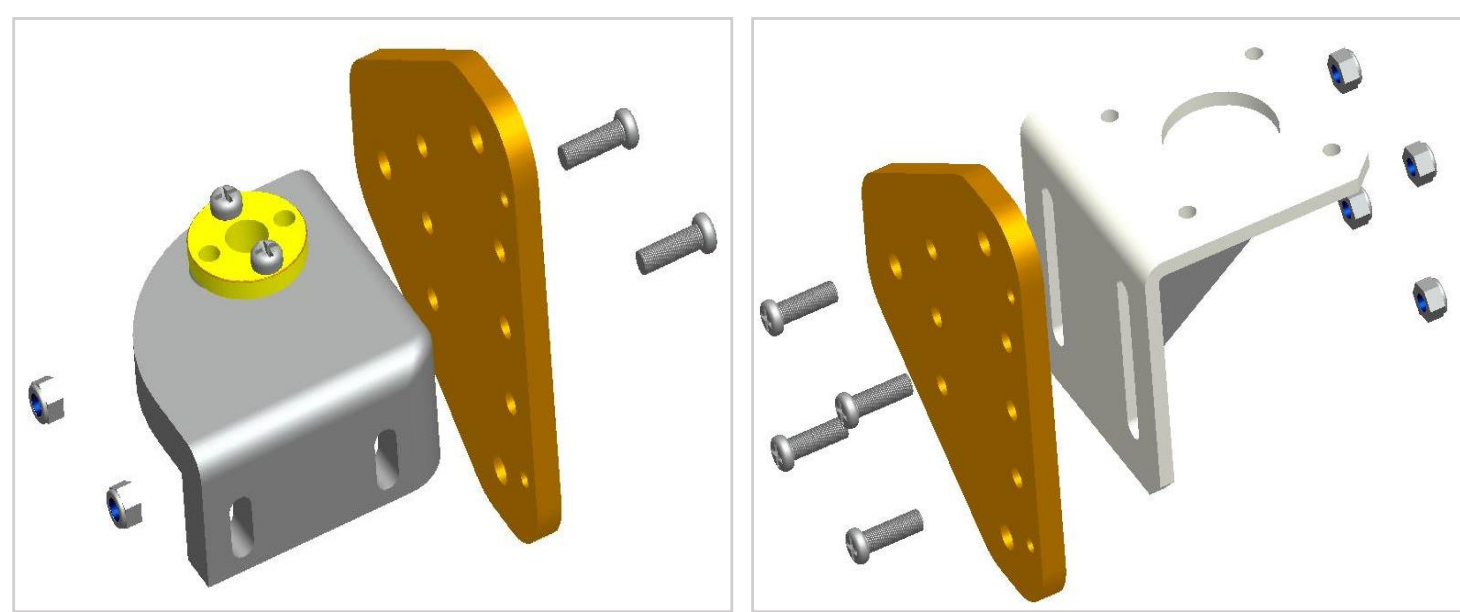

Step 11 Assemble the X axis

Parts:

2020 Aluminium profile 400mm – 1pcs

M4-12mm screws – 4pcs

M4 T-Nut – 4pcs

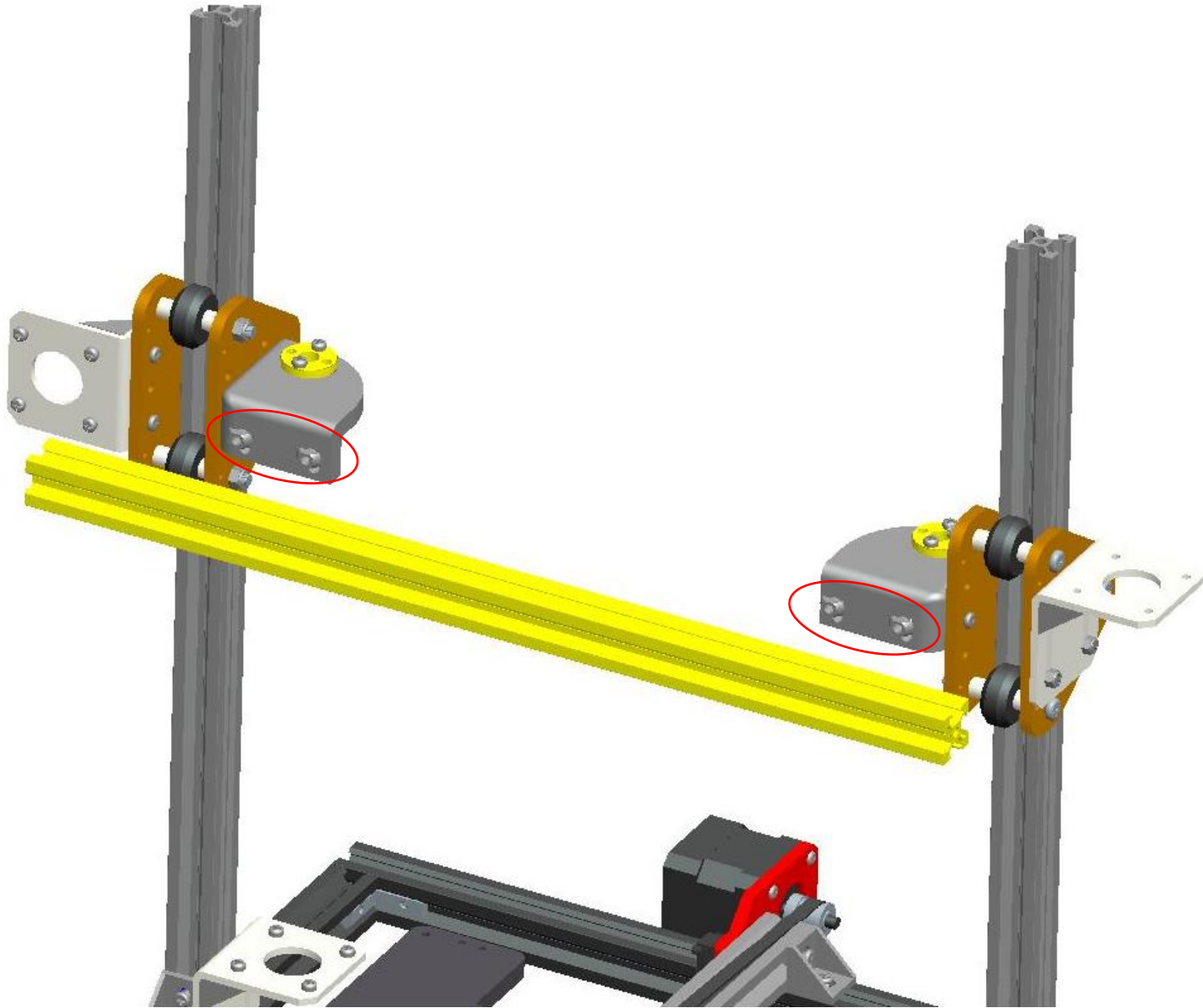

- Insert the two carriages into the Z slide rails.
- Take one 400mm Aluminium profile and attach to the brass nut holders using M4-12mm screws and T-nuts . Tighten screws gently to avoid damaging the parts.

Step 12 Place the X-motor

Parts:

42 Stepper motor – 1pcs

GT2-16 Pulley (with grub screw in it)– 1pcs

M3-6mm screw – 4pcs

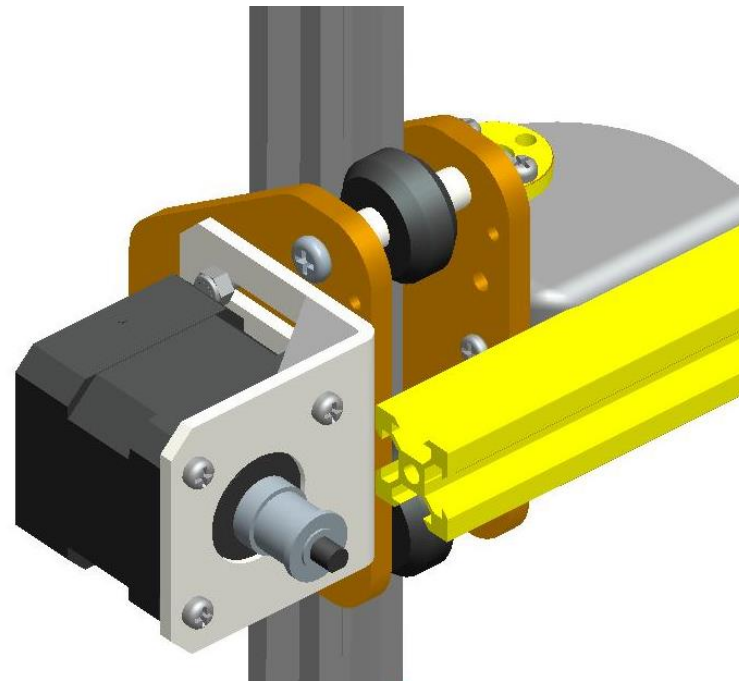
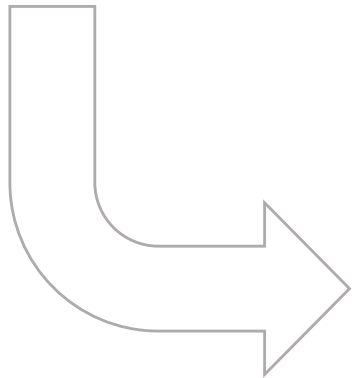
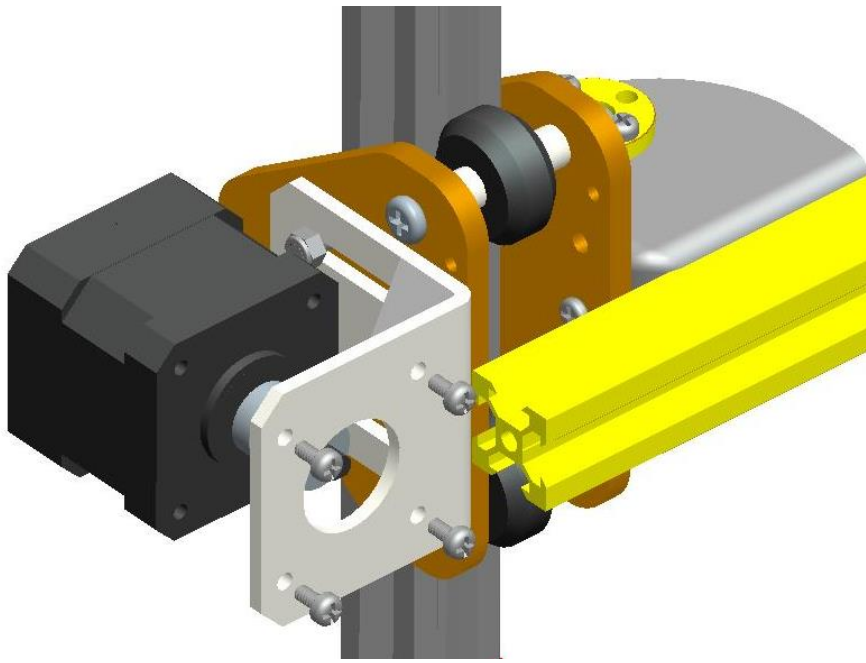

- Tighten the X-motor to the motor bracket of the left carriage , Using M3-6mm screws.
- Place GT2-16 Pulley on the motor shaft , tighten up the pulley.

Step 13 Install Filament Feeder

Parts:

- 42 Stepper motor – 1pcs
- Feeding gear (with grub screw in it)– 1pcs
- Extrusion clip - 1pcs
- Extrusion seat – 1pcs
- M3-22mm – 2pcs
- M3-16mm – 1pcs
- M5-10mm Hex screw – 1pcs
- Spring – 1pcs

- Insert the feeding gear to the motor shaft and them tighten up .
- Place the Extrusion seat and motor to the bracket as shown in the picture, secure them using 2pcs M3-22mm screws.
- Put one M5-10mm hex screw and spring between extrusion clip and extrusion seat , next secure the extrusion clip with motor using M3-16mm screw.

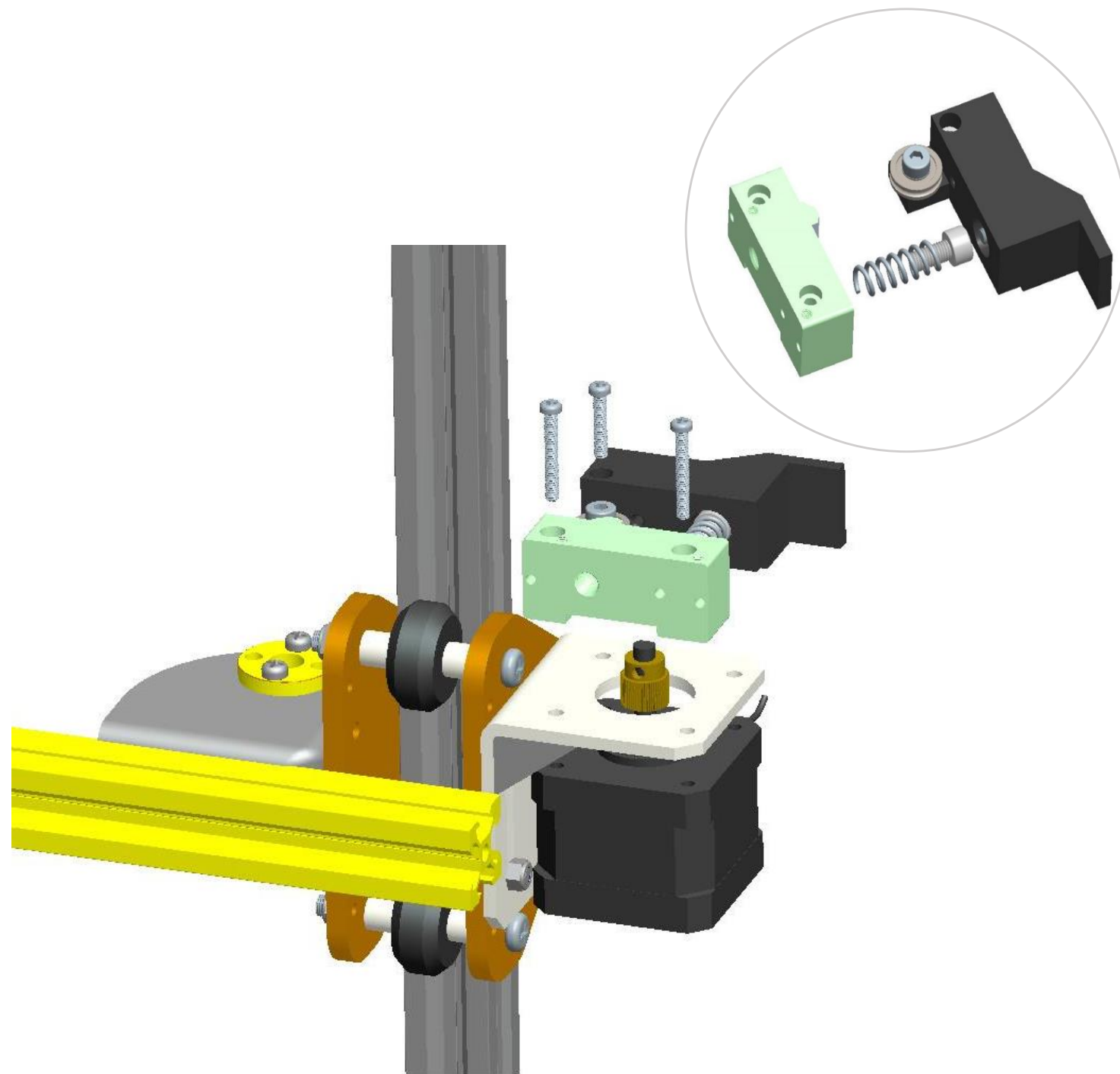

Step 14 Place the Z-Motors

Parts:

42 Stepper motor – 2pcs

Coupling (with grub screw in it) – 2pcs

M3-6mm screws – 8pcs

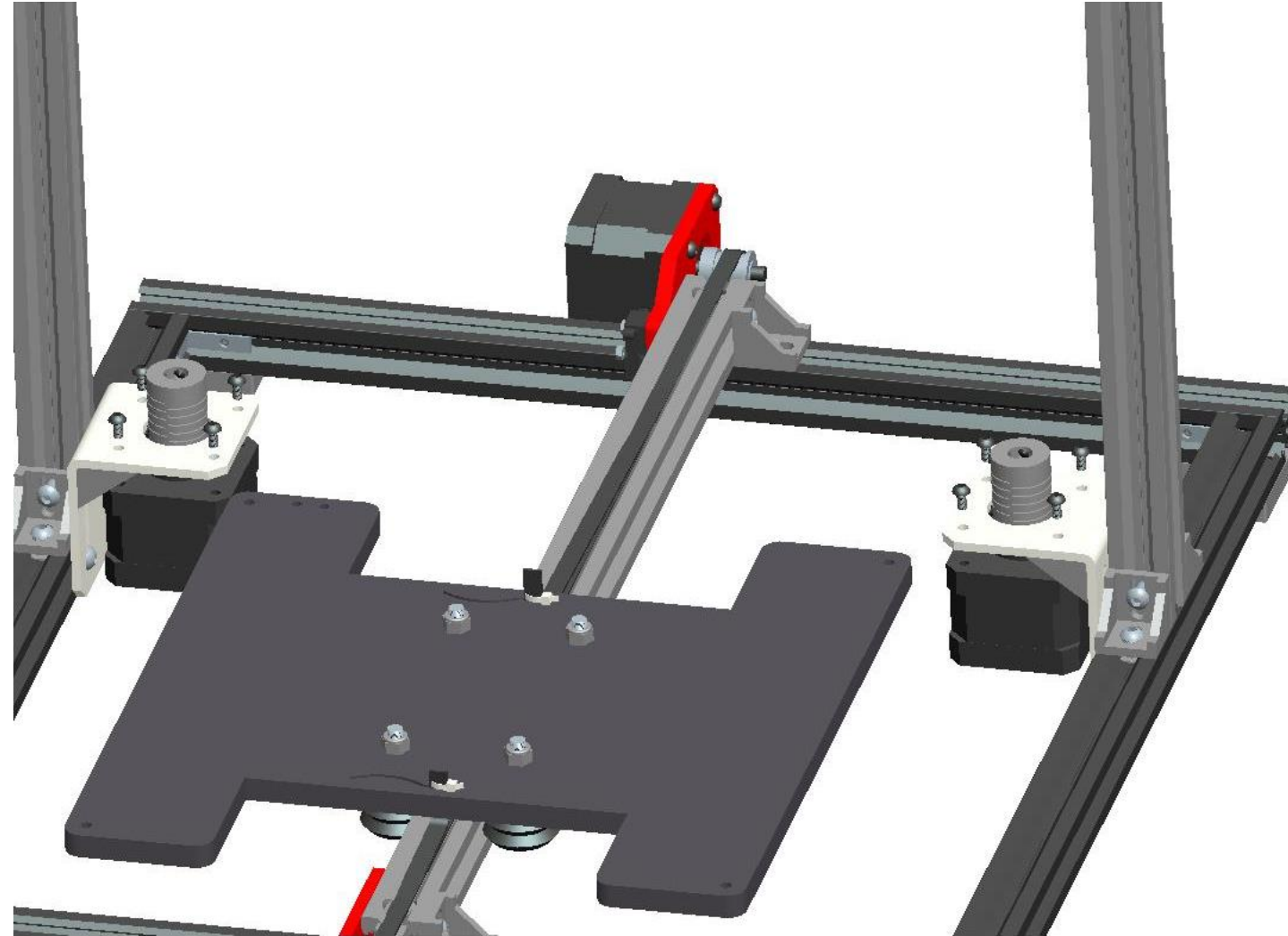

- Place the Z motors to the Z motor brackets , secure them using M3-6mm screws .
- Insert the couplings to the motor shaft. tighten the grub screws in coupling.

Step 15 Fix threaded rod

Parts:

M8 Threaded rod 380mm – 2pcs

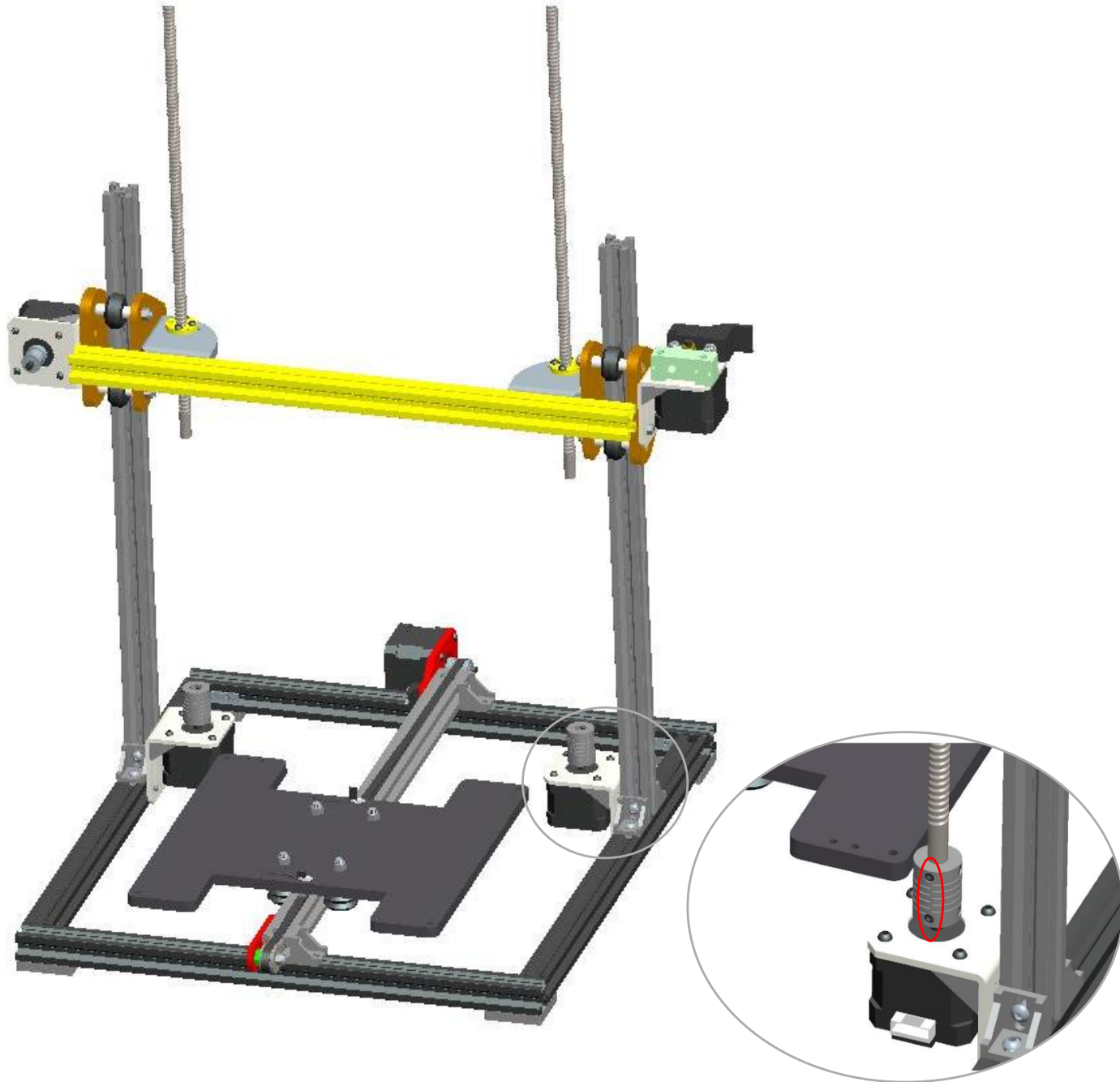

- Take 2pcs M8 threaded rod through the brass nuts ,then insert to the coupling and tighten up.

Step 16 Cover the Top

Parts:

2020 Aluminium profile 440mm – 1pcs

M5-25mm – 2pcs

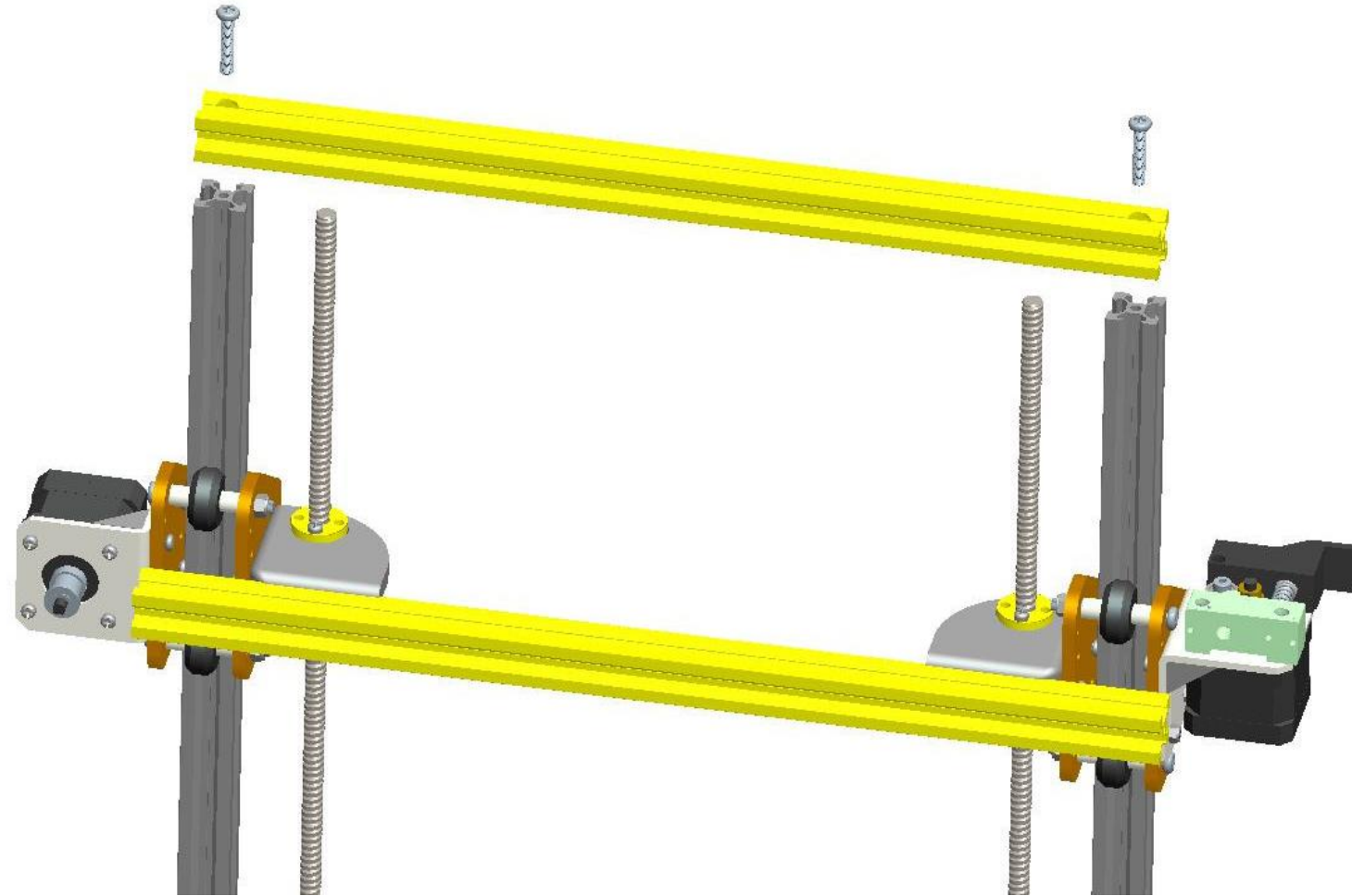

- Secure 440mm aluminium profile on the top using M5-25mm screws .

⚠ There a screw hole on the top of the Z slide rail which had been tapped.

Step 17 Insert Extruder Assembly

Parts:

Extruder assembly – 1pcs

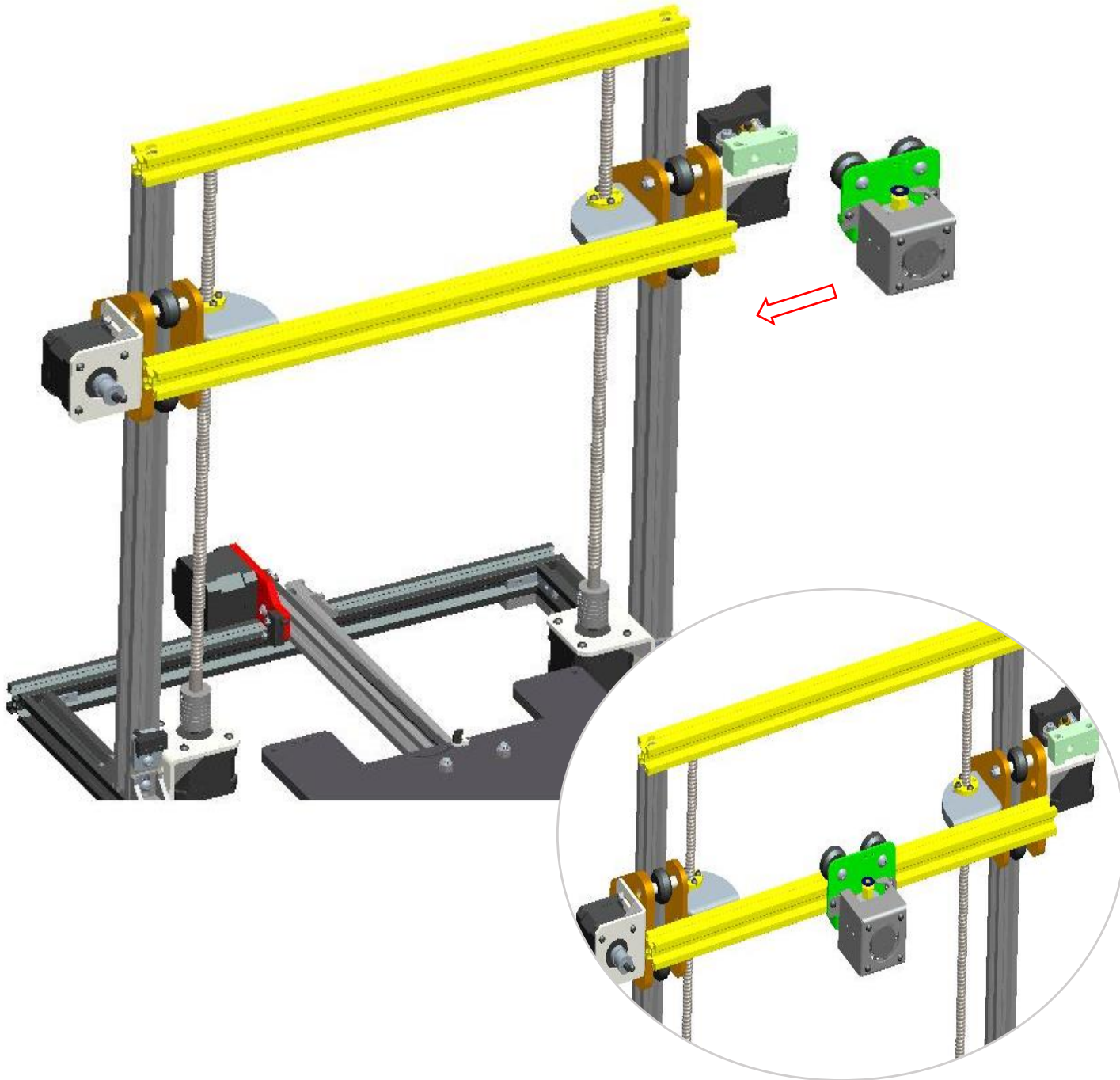

- Carefully insert the extruder assembly to the X slide rail.

Step 18 Assemble X axis Belt Pulley

Parts:

- Belt pulley – 1pcs
- X Pulley mount (acrylic) – 1pcs
- M5-25mm screw – 1pcs
- M5 Nut – 1pcs
- M5 Locknut – 1pcs
- M6 washer – 2pcs
- M5 washer – 2pcs
- M4-8mm screw – 2pcs
- M4 T-Nut - 2pcs

- Take 1pcs M5-25mm screw and insert the Pulley mount, secure it with M5 nut , then insert the washers and belt pulley , secure them using M5 locknut. (same as step 6)
- Secure the X belt pulley assembly on the right of the X slide rail using 2pcs M4-8mm screws and nuts.
- ⚠ Tighten screws gently to avoid damaging the acrylic.

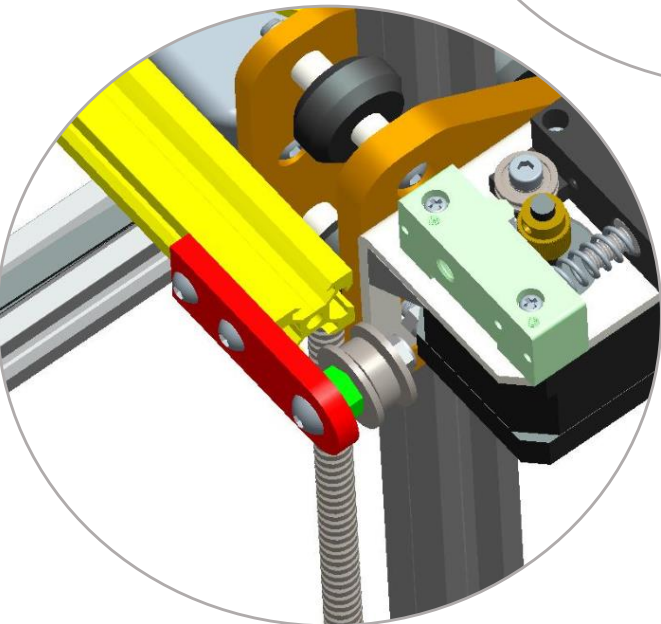
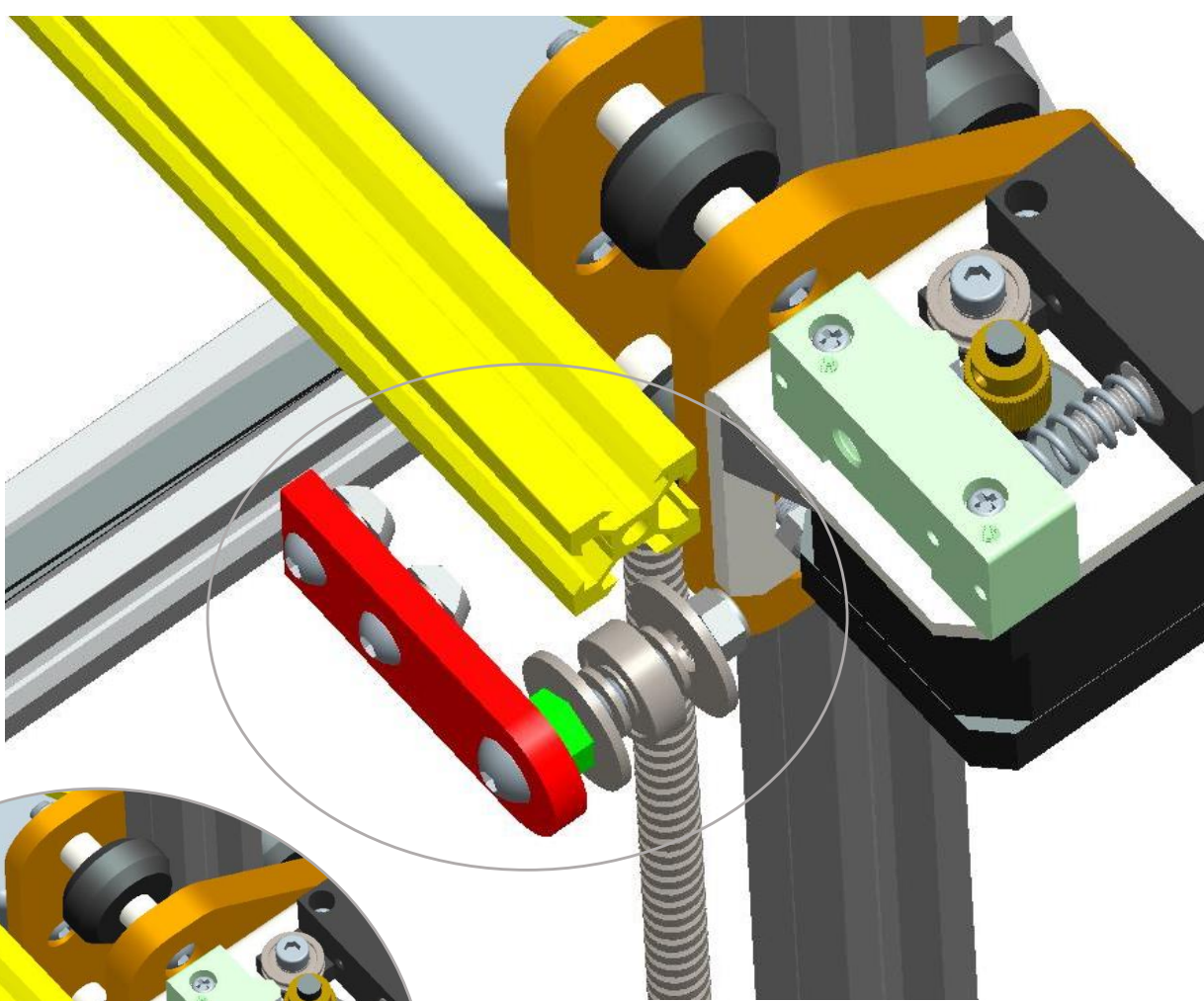

Step 19 Install X endstop

Parts:

- Limit switch – 1pcs
- X endstop mount (acrylic) – 1pcs
- M4-8mm screw – 2pcs
- M4 T-Nut – 2pcs
- M2-10mm screw – 2pcs
- M2 Nut – 2pcs

- Secure the limit switch to X endstop mount using 2pcs M2-10mm screws and nuts.
- Place the X endstop mount to the left end of the X slide rail using 2pcs M4-8mm screw and T-nuts.

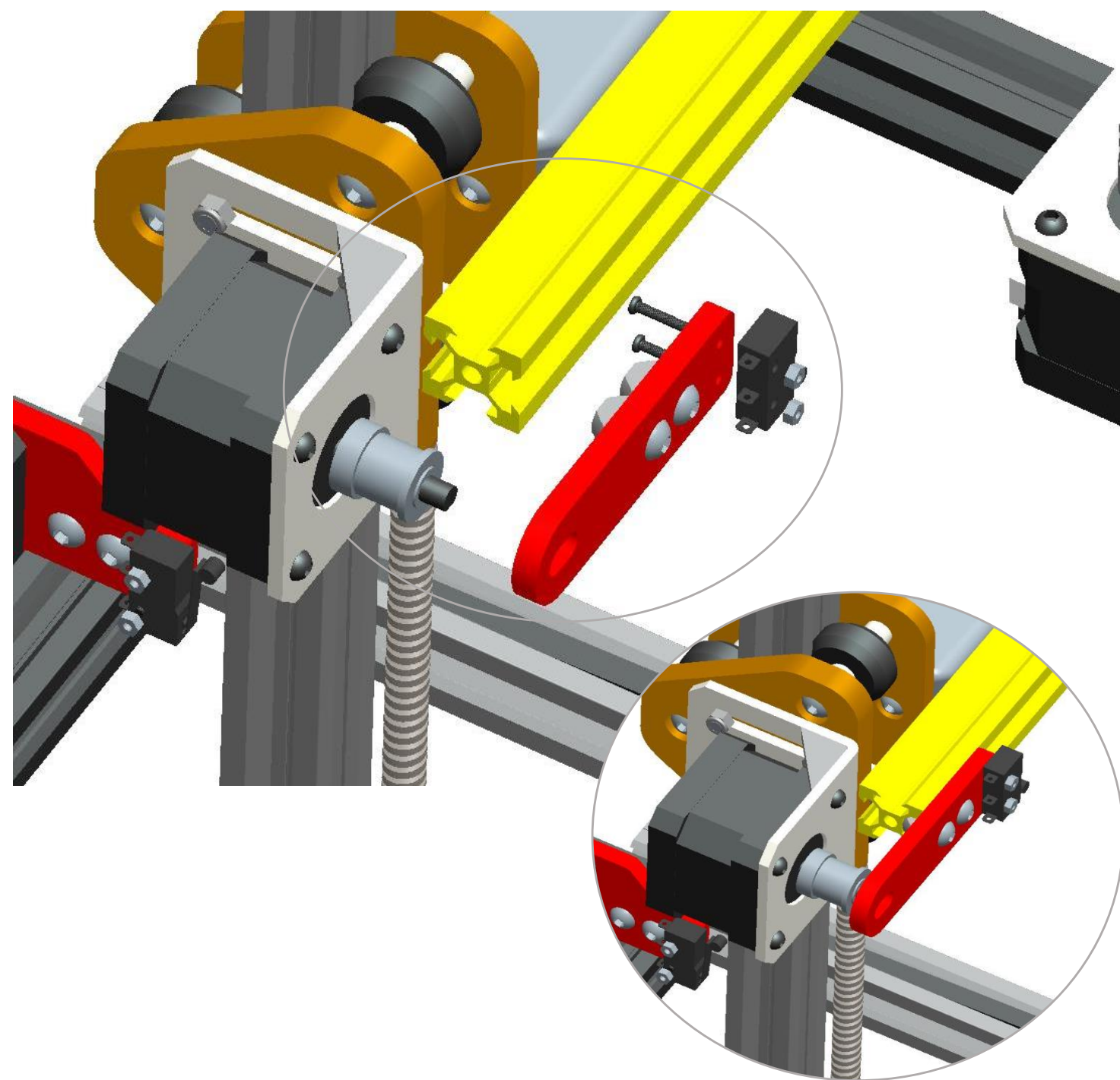

Step 20 Install X axis Timing Belt

Parts:

GT2 Timing belt – 1pcs

Zip-ties – 2pcs

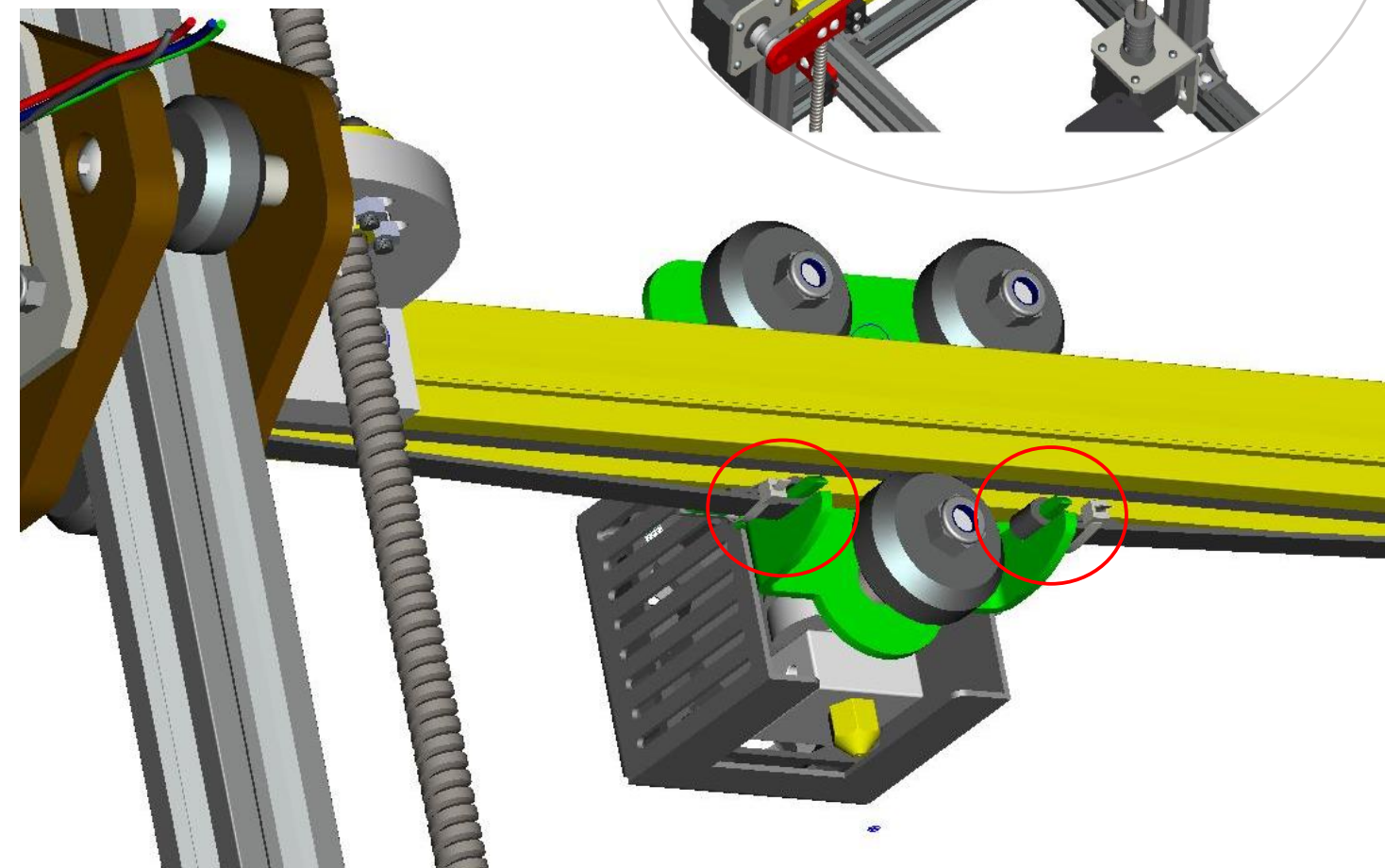

- Tighten one end of the timing belt to the belt hole using a zip-ties which back of the extruder
- Run the other end of timing belt along the aluminium profile, through the X-GT2-16 Pulley and Belt pulley . Then tighten it to another belt hole using a zip-ties, as shown in the picture .

Step 21 Assemble Heat Bed Frame

Parts:

- MK3 Heatbed – 1pc
- M3-30mm screw – 4pcs
- Thumb nut – 4pcs
- Spring – 4pcs

- Place the MK3 heatbed on the bed frame use 4pcs springs between them and then through 4pcs M3-30mm screws, then top 4pcs thumb nuts under the bed frame.

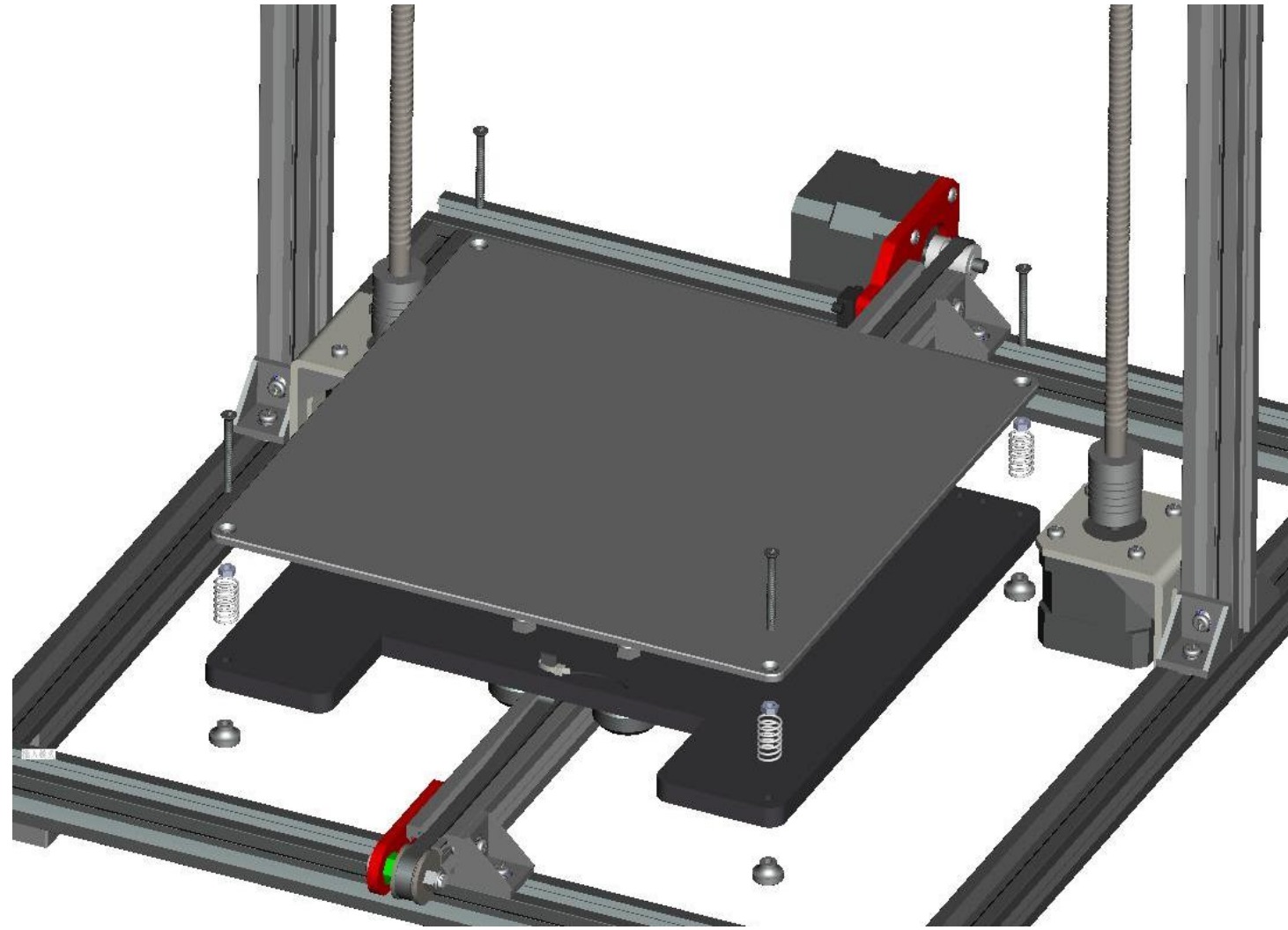

Step 22 Install Z endstop

Parts:

Limit switch – 1pcs

Z endstop mount – 1pcs

M4-8mm screw – 1pcs

M4 T-Nut – 1pcs

M2-10mm screw – 2pcs

M2 Nut – 2pcs

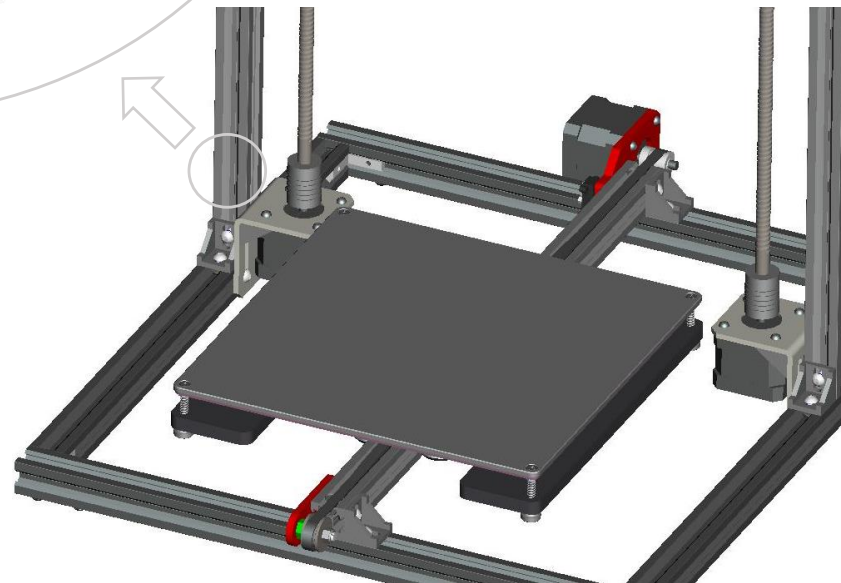
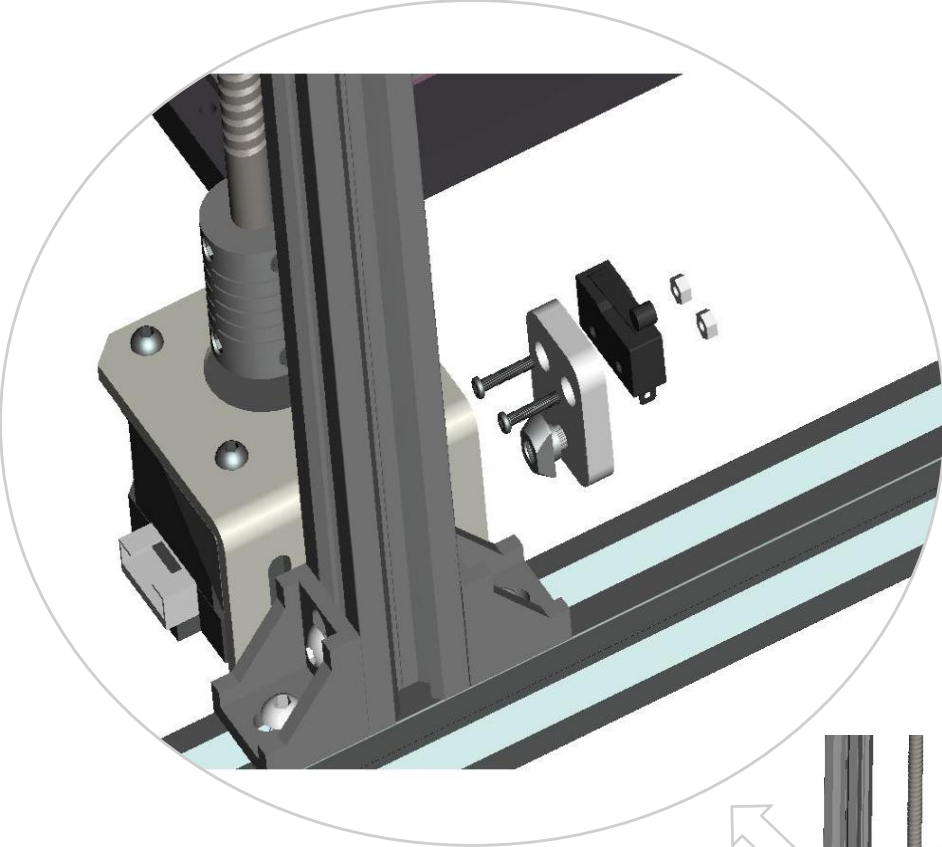

- Secure the limit switch to Z endstop mount using 2pcs M2-10mm screws and nuts.
- Place the Z endstop mount to the left Z slide rail near the left motor bracket , using one M4-8mm screw and T-nut.

Step 23 Install Teflon hose

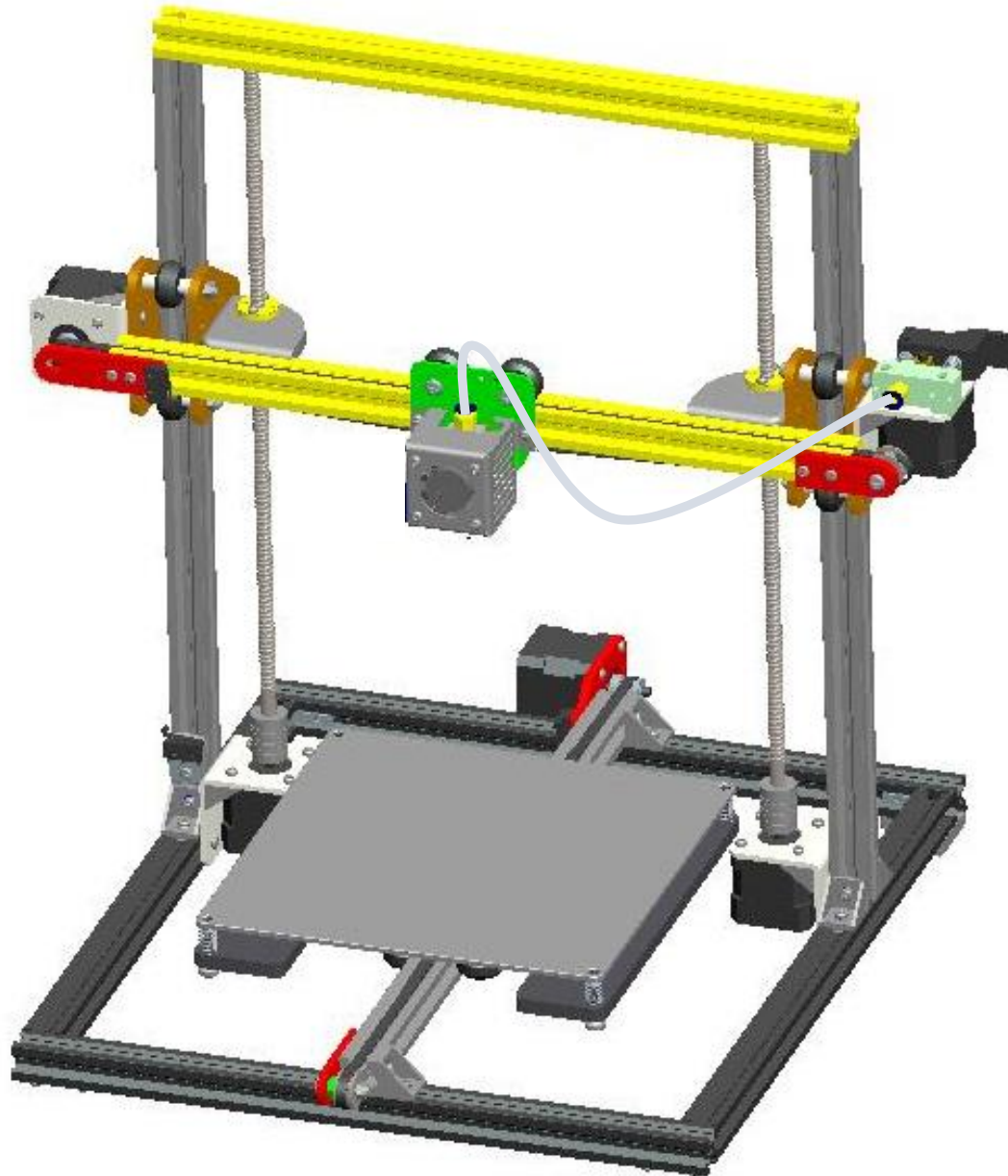

Parts:

Teflon hose – 1pcs

Connector – 1pcs

- Install a connector to the filament feeder , and then insert a teflon hose between feeder and extruder .

Step 24-1 Assemble Electronic Box

Parts:

Electronic box bottom plate (acrylic) – 1pcs

Power supply – 1pcs

Mainboard – 1pcs

M3-10mm screws – 4pcs

M3-20mm screws – 4pcs

M3 nuts – 4pcs

Plastic pillar – 4pcs

- Place the power supply on the bottom plate using M3-10mm screws.
- Place the mainboard on the bottom plate using M3-20mm and nuts, insert the plastic pillar between them.

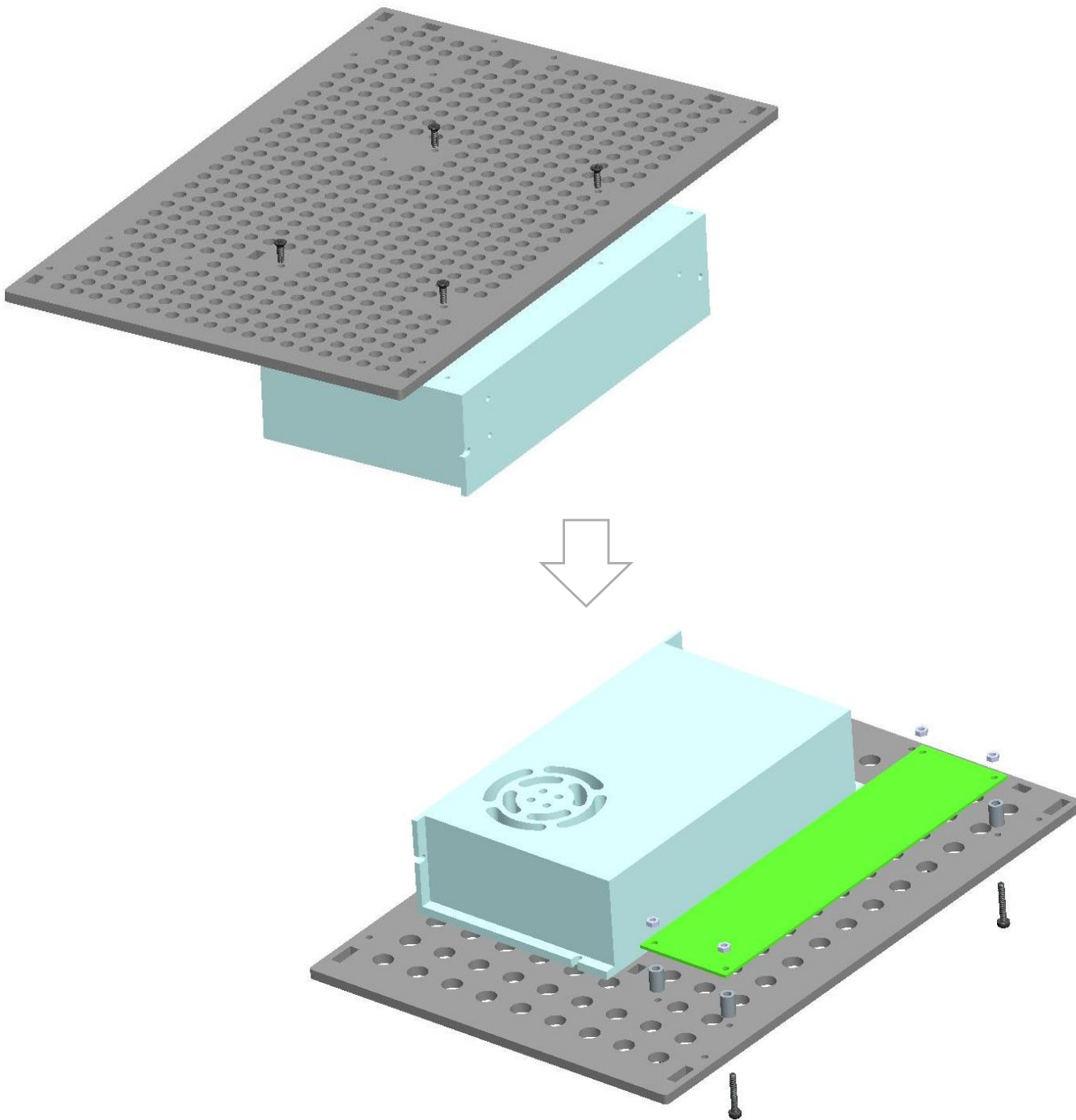

Step 24-2 Assemble Electronic Box

Parts:

Electronic box side plate (left) – 1pcs

Side plate (right) – 1pcs

Middle plate – 1pcs

Back plate – 1pcs

AC power switch

M3-10mm screw – 2pcs

M3-20mm screws – 6pcs

M3 nuts – 8pcs

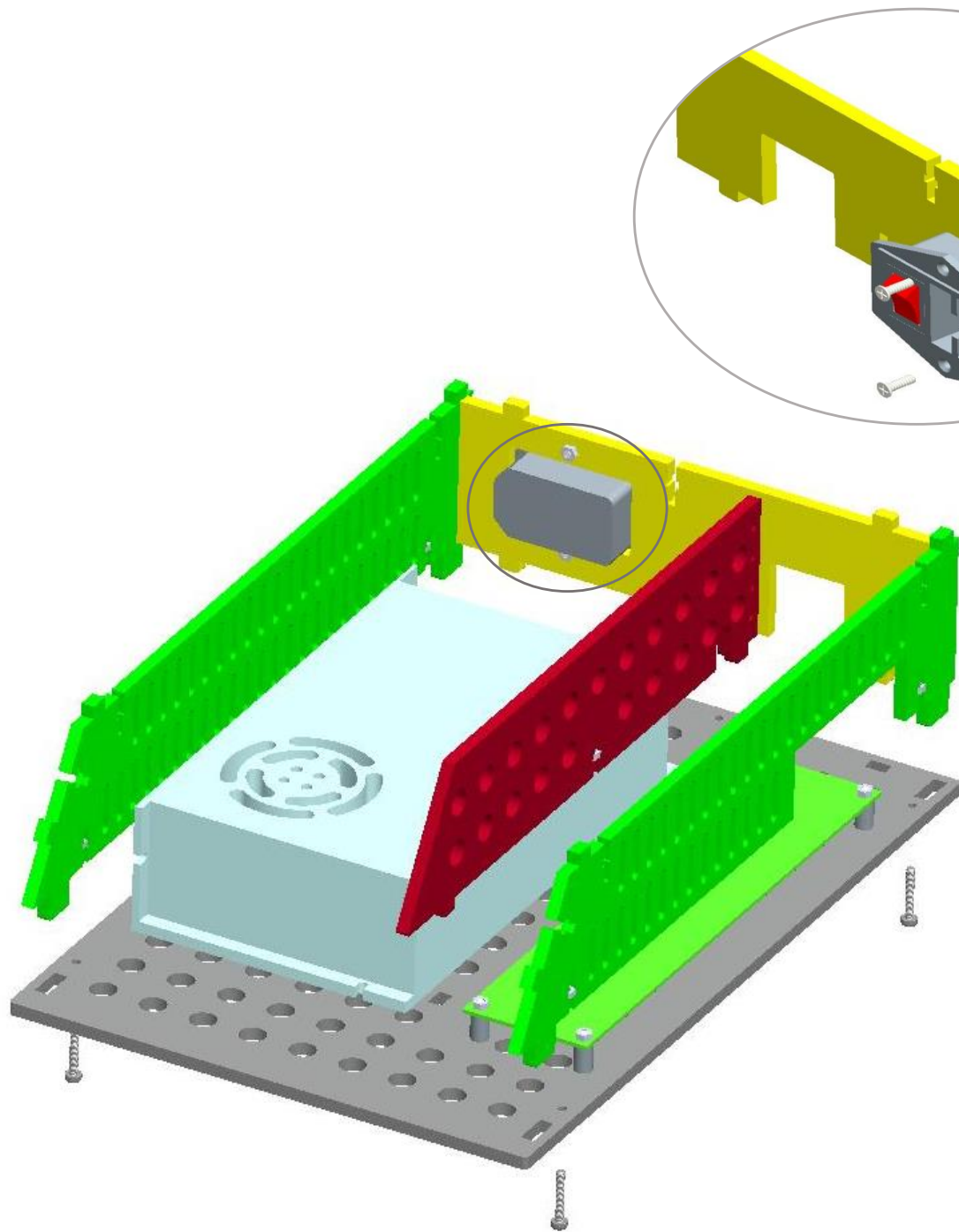

- Insert the AC power switch to the back plate , secure them using 2pcs M3-10mm screws and nuts
- Assemble the plates to the bottom plate as picture , secure them using M3-20mm screws and nuts.

Step 24-3 Assemble Electronic Box

Parts:

Electronic box top plate – 1pcs

LCD display assembly – 1pcs

M3-20mm screws – 7pcs

M3 nuts – 7pcs

- Cover the top plate using M3-20mm screws and M3 nuts.
- Place the LCD display assembly to the box , using 2pcs M3-20mm screws and nuts.

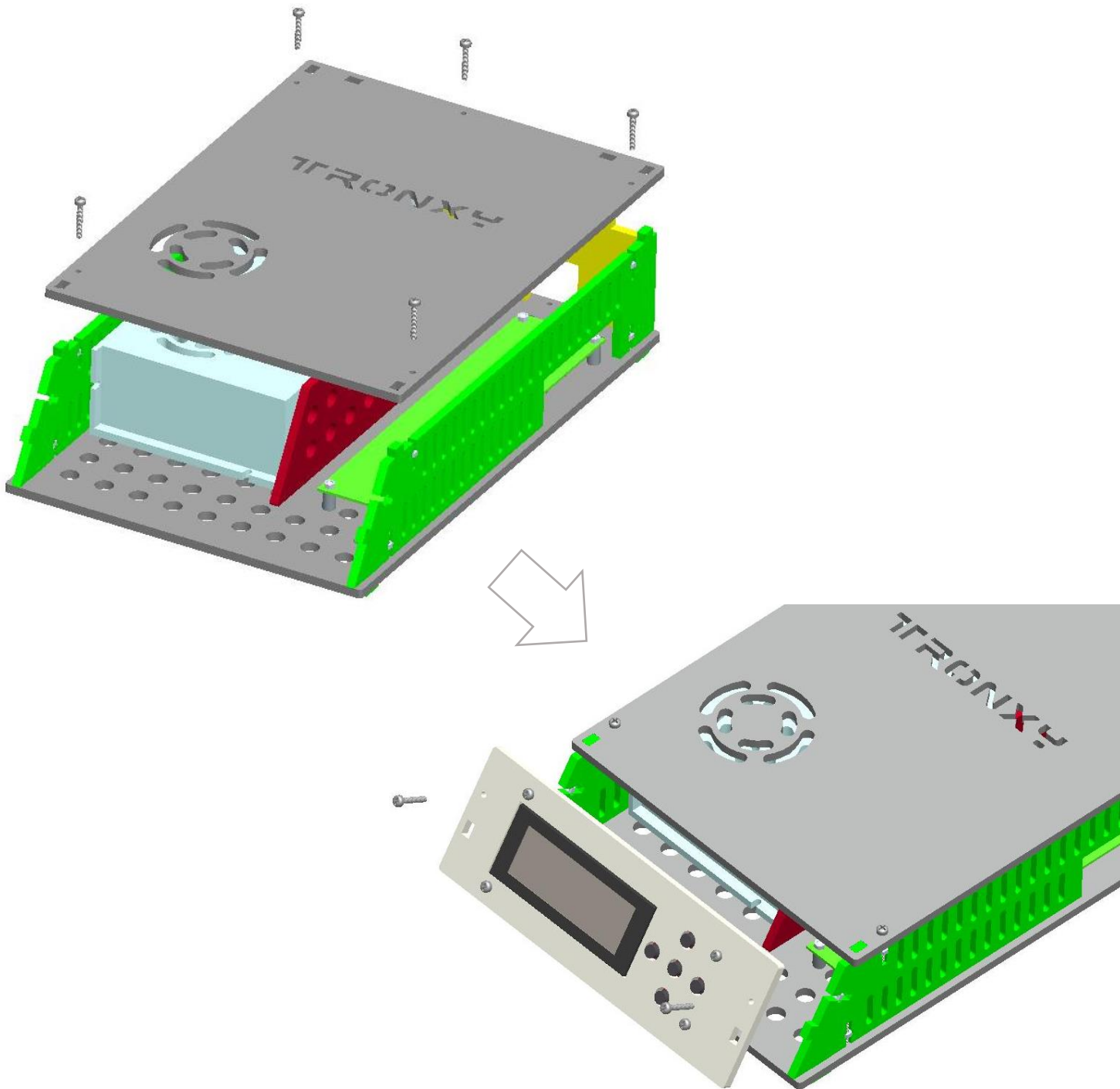

Step 24 Control Board Wiring Diagram

Parts:

Mainboard – 1pcs

- The method of connecting wire is as picture

- ⚠ There is only 1pcs cooler fan , please connect to 'CFAN' on board

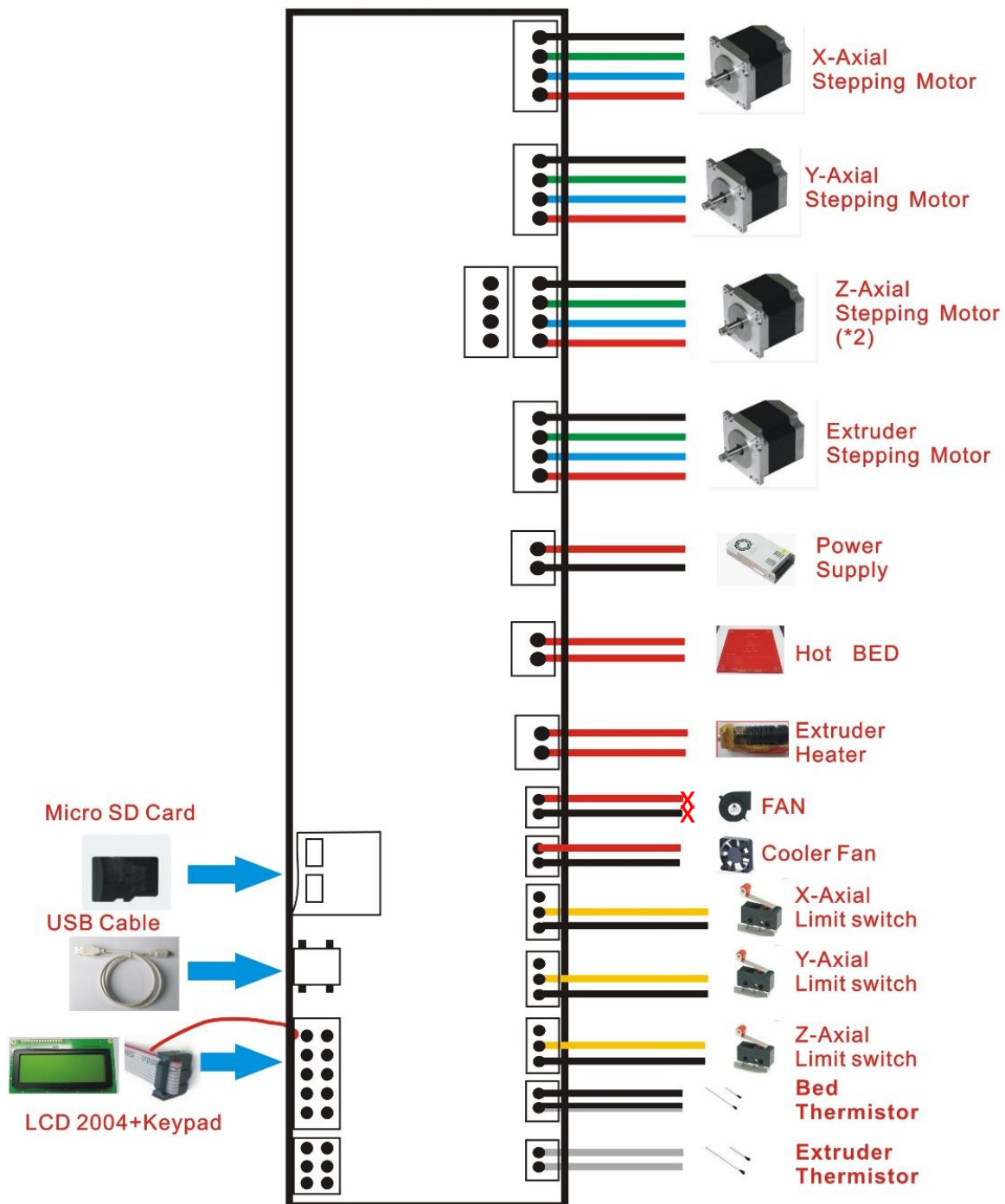

Step 25 AC Power Connector Wiring Diagram

Parts:

Power supply – 1pcs

Power switch – 1pcs

- Connect Power cable as the picture (Right)

Note: There are different voltages in different country.
Please select the appropriate voltage by switch before power on. As the picture below.

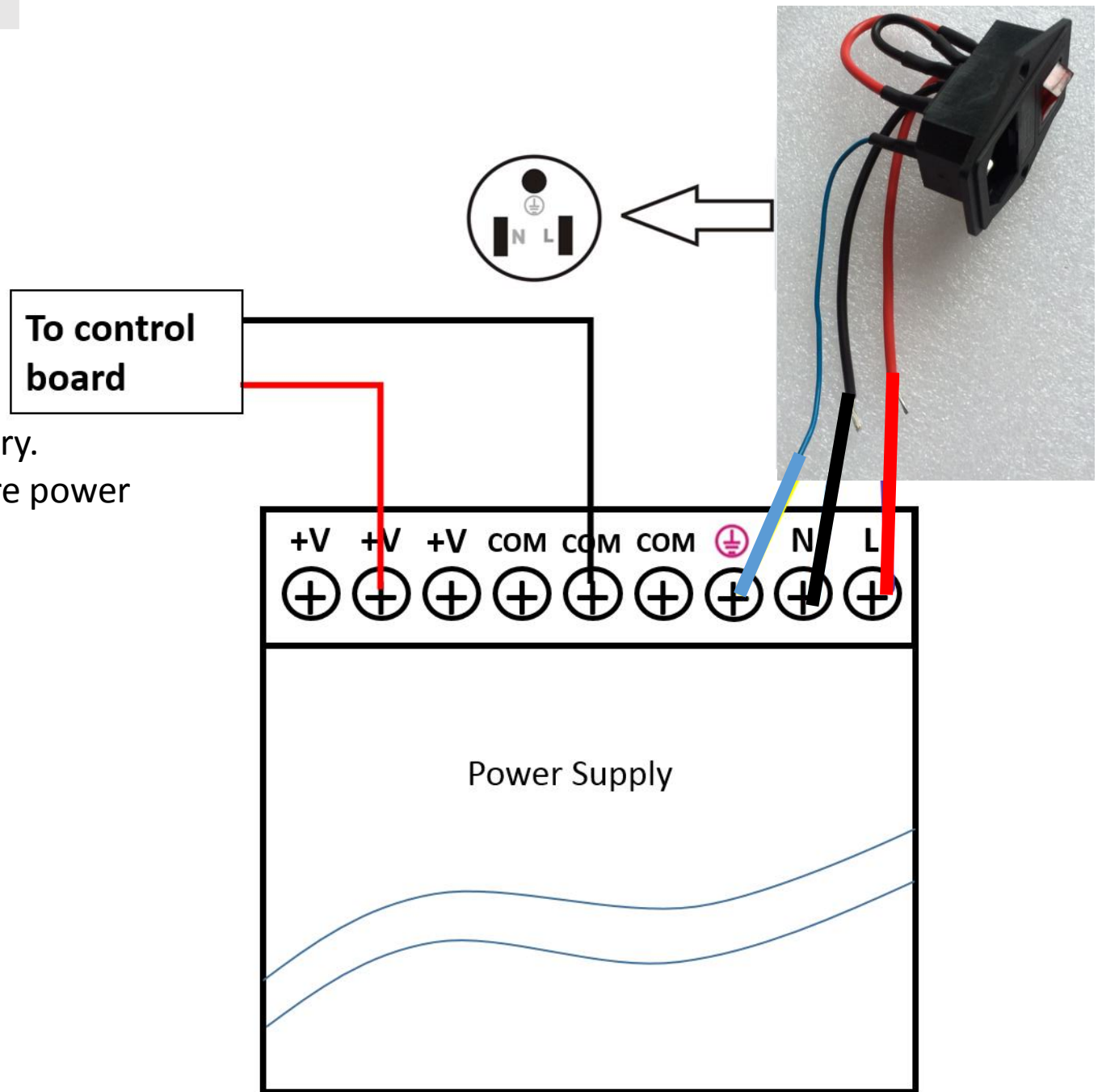

Step 26 Assemble Filament Holder

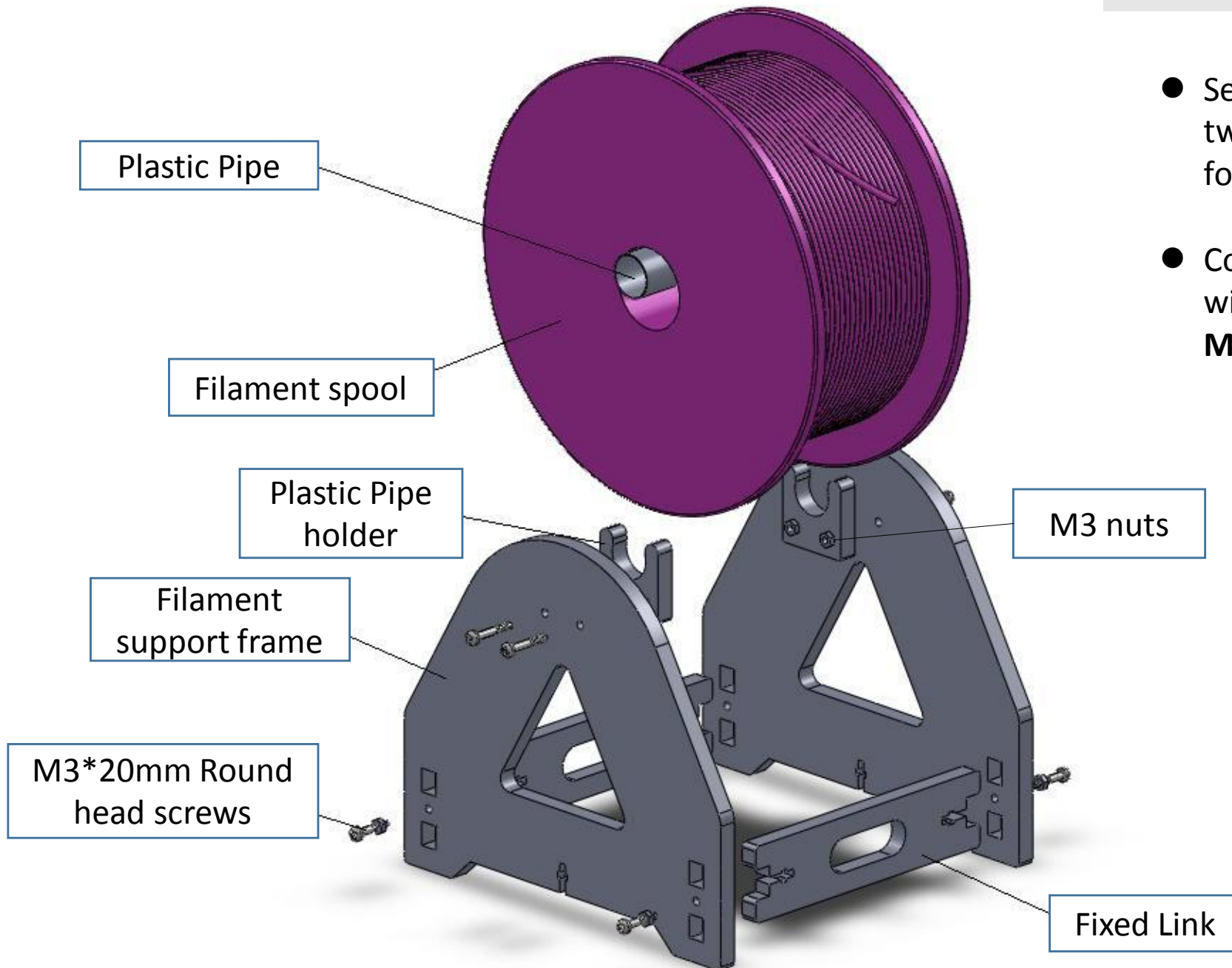

- Separately put two **Plastic Pipe holder** on two **Filament support frame**, locking with four **M3*20mm Round head screws & nuts**.
- Connect the two **Filament support frames** with two **Fixed links**, locking with four **M3*20mm Round head screws & nuts**